

ISHL

10

FINAL PROGRAM

October 22–25
2016

COLOGNE
GERMANY

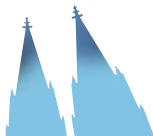

accredited by



and "Ärzttekammer
Nordrhein (AEKNO)"

GHSG 
www.ghsq.org

Saturday (22.10.2016)

09:00 – 10:30 Workshops

- New Concepts of Radiation Field Design, Advanced Technologies and New Normal Organ Constraints (R. Hoppe, J. Yahalom)
- Epidemiology and Registry Data (M. Björkholm, N. Spector)

Coffee Break

10:45 – 12:15 Workshops

- Pathology and Pathogenesis (A. van den Berg, A. Rosenwald)
- PET (B. Cheson, M. Hutchings)

12:45 – 13:45 Celgene Symposium
Recent Advances in the Treatment of Lymphoma
(A. Engert)

14:00 – 15:30 Workshops

- Biomarkers (C. Steidl, B. von Tresckow)
- Elderly Patients (B. Böll, J. Friedberg)
- GHSG WS (GHSG participants only) (M. Fuchs, A. Engert)

Coffee Break

16:00 – 17:30 Workshops

- Genetics and Microenvironment (R. Küppers, M. Shipp)
- NLPHL (J. Connors, A. Engert)
- Late Effects (L. Specht, F. van Leeuwen)

17:45 – 19:15 Novartis Symposium
Into the Future – New Treatment Options for Hematologic Malignancies
(P. Borchmann)

Sunday (23.10.2016)

07:30 – 08:30 Mundipharma Symposium
The Evolution of Chemotherapy: Using the A-DAC Principle to Unlock New Treatment Options in Hodgkin Lymphoma
(V. Diehl)

08:30 – 10:00 Interactive Case Discussions

(Faculty: P. Borchmann, F. Cavalli, R. Hoppe, J. Raemaekers)
Presenters: M. André, R. Advani, P. Bröckelmann, M. Hertzberg)

Coffee Break

10:30 – 12:00 MRD and Prediction
(M. Meignan, P. L. Zinzani)

- Clinical – IPS and other scores (J. Friedberg)
- Serum marker (A. Diepstra)
- Circulating Cell-free DNA in HL (P. Vandenbergh)
- Three Oral Abstract Presentations

12:15 – 13:45 Amgen Symposium
New Insights in the Treatment and Management of Lymphoid Malignancies
(M. V. Mateos)

14:00 – 15:30 Workshops

- Immunomodulation (P. Armand, T. Illidge)
- Current Concepts in Allo TX (A. Hagenbeek, A. Sureda)
- Grey Zone Lymphoma (B. Coiffier, W. Wilson)

Coffee Break

16:00 – 17:30 prIME Oncology, supported by Takeda Oncology
Relapsed / Refractory Hodgkin Lymphoma: Nuances in Therapeutic Strategies to Improve Outcomes – a Case Based Program
(A. Engert)

17:45 – 19:45
Opening Ceremony

Welcome Reception

Monday (24.10.2016)

07:30 – 08:30 Janssen-Cilag Symposium
Future Directions in Lymphoma and Myeloma Therapy
(B. Eichhorst)

08:30 – 10:00 Biology and Micro-environment
(S. Mathas, M. Shipp)

- Genetic lesions in HRS cells and their relationship to CD30+ B cells (R. Küppers)
- Exome-sequencing in HL (E. Tiacci)
- Gene expression profiling of the HL microenvironment (C. Steidl)
- Three Oral Abstract Presentations

Coffee Break

10:30 – 12:00 Immunotherapy (Basic Science)
(A. Moskowitz, H. Stein)

- PD1 / PD-L1 / L2 assessment in HL (M. Shipp)
- Mode of action of PD1 / PD-L1 MoAbs in HL (A. Moskowitz)
- Other new approaches (A. van den Berg)
- Three Oral Abstract Presentations

12:15 – 13:45 Bristol-Myers Squibb Symposium
Evolving Therapy in the HL Treatment Landscape
(A. Engert)

14:00 – 15:30 PET – Where Are We?
(M. Dietlein, J. Radford)

- PET Update 2016 (B. Cheson)
- WS report „Is PET as good as we think?“ (M. Meignan)
- Visual and quantitative PET/CT (C. Kobe)
- Three Oral Abstract Presentations

Coffee Break

16:00 – 17:30 Early Stages
(H. T. Eich, A. Lister)

- Early favorable HL: Pros and cons of PET-adapted therapy (M. Hutchings)
- Early unfavorable: New standard of care? (J. Raemaekers)
- NLPHL (D. Eichenauer)
- Three Oral Abstract Presentations

17:45 – 19:15 Medscape Education Symposium
Managing Hodgkin Lymphoma – A World View
(A. Engert)

Tuesday (25.10.2016)

07:30 – 08:30 Bristol-Myers Squibb Symposium – Ask the Expert: An Open Forum on Hodgkin Lymphoma (Moderator: P. Armand, Panelists: C. Moskowitz, G. Collins, C. S. Diefenbach, V. Ribrag)

08:30 – 10:00 Pediatric HL
(C. Mauz-Körholz, N. Spector)

- Interim results of EuroNet-PHL-C1 (J. Landman-Parker)
- Targeted agents in pediatric HL (M. Metzger)
- COG / ECOG: AYA HL (K. Kelly)
- Three Oral Abstract Presentations

Coffee Break

10:30 – 12:00 Advanced Stages
(M. Federico, V. Diehl)

- Debate: PET-guided ABVD versus old school BEACOPP (P. Johnson, P. Borchmann)
Moderator: A. Hagenbeek
- Perspectives in advanced HL (P. Brice)
- Three Oral Abstract Presentations

12:15 – 13:00 Roche Symposium
Classification of New Therapeutic Options for CLL and Follicular NHL
(K. Hübel)

13:00 – 13:45 Poster Walk

14:00 – 15:30 Relapsed HL
(P. Brice, J. Armitage)

- Brentuximab vedotin in relapsed HL (C. Moskowitz)
- Clinical results with anti-PD(L)1 antibodies in HL (P. Armand)
- Role of allo-Tx in the PD1 era (F. Morschhauser)
- Three Oral Abstract Presentations

Coffee Break

16:00 – 17:30 Survivorship
(F. van Leeuwen, P. Borchmann)

- Fatigue (K. Behringer)
- Survivorship surveillance (A. Fossa)
- Second malignancies (F. van Leeuwen)
- Three Oral Abstract Presentations

17:45
Closing Remarks
(A. Engert)

Scientific Sessions / Main Program

Workshops

Educational

Satellite Symposia

Breaks



Final Program

October 22–25, 2016

Venue

Gürzenich Cologne
Martinstraße 29–37
50667 Cologne



German Hodgkin Study Group
Chair: Prof. Dr. Andreas Engert

Imprint

Prof. Dr. Andreas Engert (Symposium Chairman)
 PD Dr. Boris Böll (Congress Secretary)
 PD Dr. Bastian von Tresckow (Congress Secretary)
 German Hodgkin Study Group
 Department I for Internal Medicine
 University Hospital of Cologne

Hosted by:
 Department I for Internal Medicine
 University Hospital of Cologne
 Director: Prof. Dr. Michael Hallek

Design: Atelier Henri Winter

Production: Linsen Druckcenter GmbH

Photos by Courtesy of:
 Thorsten Kern, Pages 3, 14, 29, 36
 Carl Victor Dahmen, Pages 15, 35
 KölnKongress, Page 16
 unsplash.com, Page 17
 Cologne Tourist Board, Pages 18, 19



Acknowledgements

We wish to express its appreciation
 and gratitude to our partners.



Financial support was kindly provided by the Deutsche
 Forschungsgemeinschaft (DFG) within their programme
 "International Scientific Events"

Karl Musshoff Stiftung

The Karl Musshoff Stiftung kindly supports the Karl-Musshoff-
 Price for the best basic science abstract and best clinical abstract
 as well as the Young Investigator Awards.



The ONKO-Internetportal in cooperation with Deutsche
 Krebsgesellschaft e. V. is our media cooperation partner.

Sponsors

We thank the following pharmaceutical companies for supporting this Symposium

Platinum Sponsor



ONCOLOGY

Takeda Oncology | www.takedaoncology.com

Gold Sponsors



Amgen GmbH
www.amgen.de



Bristol-Myers Squibb
www.bms.com



Celgene GmbH
www.celgene.de



Novartis Pharma GmbH
www.novartis.de

Silver Sponsors



Janssen Research & Development, LLC
www.janssenrnd.com



Mundipharma EDO GmbH
mundipharma-edo.com



Roche Pharma AG
www.roche.de

Bronze Sponsors

Acromion GmbH
www.acromion-gmbh.com

Affimed Therapeutics AG
www.affimed.com

Astra Zeneca GmbH
www.astrazeneca.de

Chugai Pharma
www.chugai-pharma.de

HEXAL AG
www.hexal.de

Managing Hodgkin Lymphoma
www.managinghodgkinlymphoma.com

MSD
www.msd.com

Sanofi Genzyme
www.genzyme.de

Bristol-Myers Squibb

At the Forefront
of Immuno-Oncology

ADVANCING
HEMATOLOGY RESEARCH



Bringing the science of
Immuno-Oncology into
hematologic malignancies



Bristol-Myers Squibb



Immuno-Oncology

©2016 Bristol-Myers Squibb Company

IODE16NP04712-01-01 07/16

Conference Committee

Organizing Committee

Prof. Dr. Andreas Engert (Symposium Chairman)

PD Dr. Boris Böll (Congress Secretary)

PD Dr. Bastian von Tresckow (Congress Secretary)

German Hodgkin Study Group

Department I for Internal Medicine

University Hospital of Cologne

Kerpener Straße 62

D-50924 Cologne

Phone: +49 (0) 221.478-5933

Fax: +49 (0) 221.478-3778

Email: info@hodgkinsymposium.org

Further Information: www.hodgkinsymposium.org

Conference Management & Industrial Exhibition Secretariat

Gabriele Hanke

Travel & Congress Activities

Marienburger Str. 8; D-40883 Ratingen

Phone: +49 (0) 2102.669 36

Fax: +49 (0) 2102.9648 29

Email: info@tca-hanke.de

International Scientific Committee

R. Advani, M. André, P. Armand, J. Armitage, M. Björkholm,
P. Borchmann, P. Brice, F. Cavalli, B. Cheson, B. Coiffier, J. Connors,
V. Diehl, M. Dietlein, H. T. Eich, M. Federico, J. Friedberg,
A. Hagenbeek, M. Hertzberg, R. Hoppe, M. Hutchings, T. Illidge,
P. Johnson, R. Küppers, A. Lister, S. Mathas, C. Mauz-Körholz,
M. Meignan, F. Morschhauser, A. Moskowitz, C. Moskowitz,
A. Polliack, J. Radford, J. Raemaekers, A. Rosenwald, M. Shipp,
L. Specht, N. Spector, C. Steidl, H. Stein, A. Sureda, A. van den Berg,
F. van Leeuwen, W. Wilson, J. Yahalom, P. L. Zinzani



...indicated for the treatment of adult patients with CD30+ HL at increased risk of relapse or progression following ASCT¹

Visit the Takeda Oncology booth to find out more



Reference: 1. ADCETRIS [summary of product characteristics]. Full Prescribing information is available at the Takeda booth. 08/2016 GON/BRE/16/0017

Table of Contents

Imprint Acknowledgements	2
Sponsors	4
Conference / Scientific Committee	7
Table of Contents	9
Exhibition	10
Welcome	13
General Information	14
Scientific Program	20
Saturday, 22.10.2016	
Hematology Educational	20
Saturday, 22.10.2016	
Workshops Satellite Symposia	21
Sunday, 23.10.2016	
Scientific Program Satellite Symposia Workshops	25
Opening Ceremony	29
Monday, 24.10.2016	
Scientific Program Satellite Symposia	30
Tuesday, 25.10.2016	
Scientific Program Satellite Symposia Closing Remarks	33
Abstracts	
Biology and Microenvironment	37
Early Stages	42
Advanced Stages	45
Immunotherapy (Basic Science)	49
MRD and Prediction	50
Pediatric Hodgkin Lymphoma	52
Positron Emission Tomography (PET)	55
Relapsed Hodgkin Lymphoma	56
Survivorship	63
Speakers and Chairs	70
FSA-Kodex	73
Award Winners ISHL10	74

- | | |
|-----------------------------------|----------------------|
| 1 Takeda | 2 Janssen-Cilag GmbH |
| 3 MSD | 4 Roche Pharma GmbH |
| 5 Managing Hodgkin | 6 Amgen GmbH |
| 7 Bristol-Myers Squibb | 8 HEXAL AG |
| 9 Sanofi Genzyme | 10 Chugai Pharma |
| 11 Astra Zeneca | 12 Acromion GmbH |
| 13 Leukämiehilfe RHEIN-MAIN e. V. | |

Exhibition Hall

The Exhibition will take place in the Gürzenich in the "Isabellensaal" on the First Level.

Opening hours of the Exhibition

Sun. 23.10. 12:00-18:00 Mon. 24.10. 08:00-18:00

Tue. 25.10. 08:00-18:00

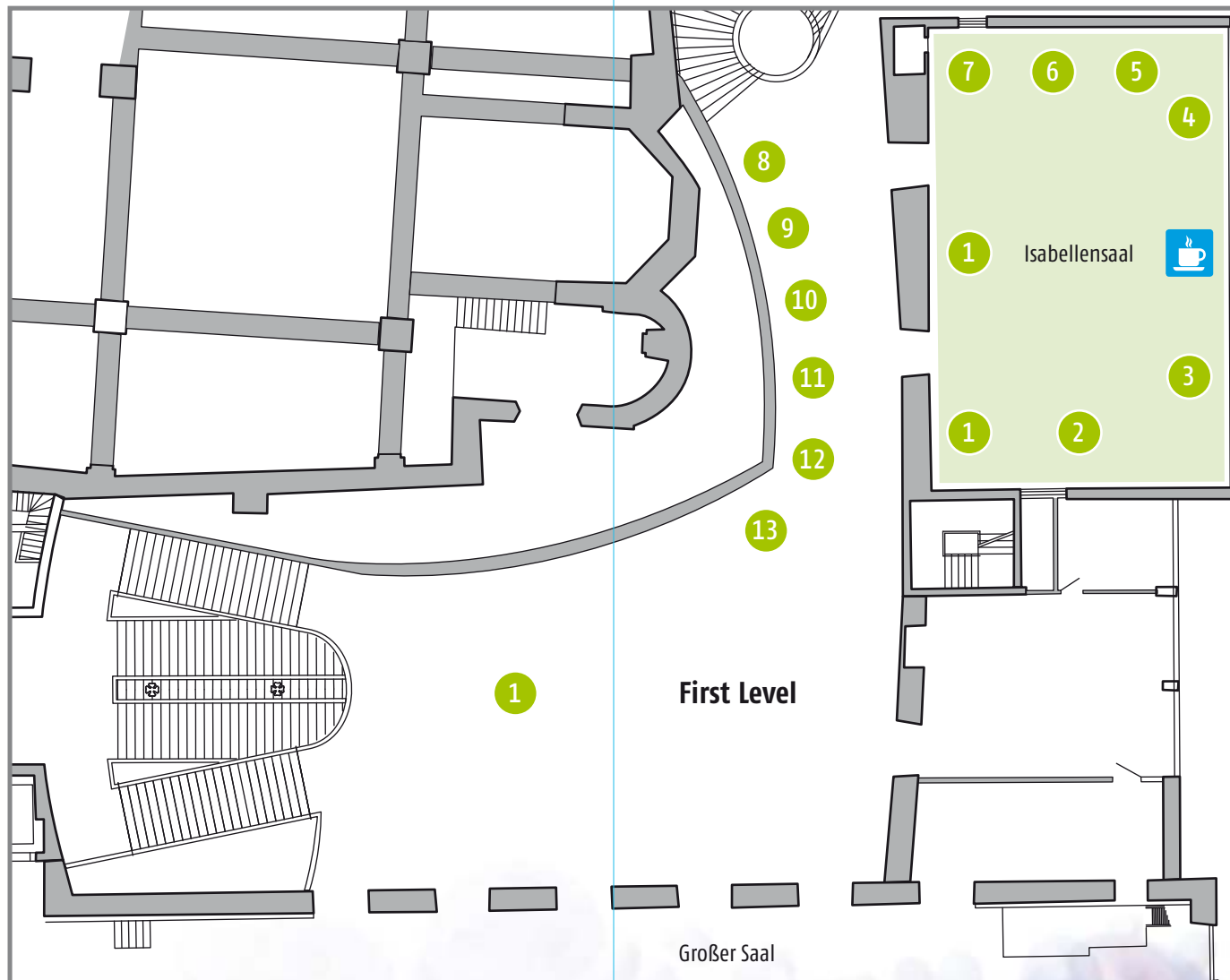

Welcome

Dear colleagues and friends,

We warmly welcome you to our 10th International Symposium on Hodgkin Lymphoma (ISHL10). This symposium has become the central forum for clinicians and scientists for a comprehensive exchange of up-to-date results and new ideas. Discussing the relevance of new findings for daily clinical practice in Hodgkin Lymphoma is one of the major goals of this symposium, which is hosted by the German Hodgkin Study Group (GHSg). It will be held again at the Gürzenich in Cologne, which is a wonderful communicative environment for scientific discussion and networking.

ISHL10 will cover the most recent results in basic research, diagnostics and treatment of Hodgkin Lymphoma and related malignancies. Satellite symposia and scientific workshops will complement the program. In addition, there will be an interactive case discussion and a Hematology Educational. This year, there is a special emphasis on Immunotherapy. The Karl-Musshoff-Price for the best basic science abstract and best clinical abstract will be presented during the opening ceremony. Additionally, five young investigator awards have been designated based on the abstract evaluation of an international committee.

We thank all our contributors and cordially welcome you to ISHL10!



Andreas Engert
Tresckow
Congress Chairman



Boris Böll
Congress Secretary



Bastian von
Congress Secretary



General Information

Conference Secretariat

Gürzenich Cologne | Martinstraße 29–37 | 50677 Cologne

During the Conference the Secretariat can be contacted at

Phone: +49 (0) 173 . 939 07 30

Email: info@tca-hanke.de

Opening Hours of the Conference Secretariat

Saturday, October 22, 2016 08:00–18:00

Sunday, October 23, 2016 07:00–18:00

Monday, October 24, 2016 07:00–18:00

Tuesday, October 25, 2016 07:00–18:00

Accommodation

If you are still in need of a hotel room, please contact the conference management:

Phone: +49 (0) 2102 . 669 36

Email: info@tca-hanke.de

Badge

Participants are requested to wear their badge at all times during the conference including satellite symposia.

A replacement fee will be charged for lost badges.

Catering

Complimentary coffee will be served during breaks at the conference. Breakfast and lunch will be available for participants of satellite symposia. There will also be the possibility of buying snacks during the breaks.



Cloakroom

A cloakroom is available in the basement.

Conference Language

The conference language is English.

There will be no translation into other languages.

Continuing Medical Education

The 10th International Symposium on Hodgkin Lymphoma will be certified by AEKNO with a total of 24 points for the entire meeting. The meeting will be also certified by the European Board for Accreditation in Hematology (formerly EHA) with 24 EBAH credit points.

Please collect your certificates before departure at the registration desk (entrance hall of the Gürzenich).

Insurance

The meeting organizers cannot accept liability of personal injuries sustained or for loss or damage of property belonging to congress participants, either during or as a result of the meeting.

Internet

All participants will have free access to High Speed Wireless Internet at the Gürzenich Conference Center at no extra cost. Further details such as access codes will be provided on site. Two internet terminals will be provided allowing internet browsing and access to web based mail.



Registration

Pre-registration will close on October 20. All registrations received on or after October 21 will be considered on site registrations and will be charged the on-site fee.

Full registration will include access to the scientific sessions and exhibition, a copy of the program and abstract book, welcome reception on Sunday October 23 and all refreshment breaks.

Name tags will be issued and will be required at all conference events including satellite symposia. No refund will be possible.

Speakers Ready Room

On all the following conference days, the Speakers Ready Room is located on the ground level of the Gürzenich Conference Center next to the registration desk. Speakers are requested to bring their PowerPoint presentations at least 3 hours before their session starts or the day before if the session starts early in the morning. Only Windows PowerPoint files can be accepted. No laptop presentations will be allowed in the session rooms.

Non-Smoking

There will be a strict non-smoking policy within all areas of the facilities used by the conference.



Transportation

The airports closest to Cologne City are Cologne / Bonn Airport (15 km) and Düsseldorf Airport (45 km).

From Cologne / Bonn Airport you can reach Cologne central station by rapid transit railway and regional express network (both 30 minutes), the trip from Frankfurt Airport to Cologne by Inter-City Express (ICE) takes just an hour.

Cologne central station is within walking distance (10 minutes) from the Gürzenich Conference Center and the Dorint Hotel. You may also take bus no. 132 to the stop "Gürzenichstraße". The other hotels recommended by the Congress Organization can easily be reached by public transport. Cologne has an efficient public transport system. Yet the recommended hotels, the venue as well as other places of interest are within a comfortable walking distance from each other. For those who are traveling by car we recommend the parking ground "Heumarkt" – about 3 minutes walking distance from the Gürzenich.

Welcome Reception

On Sunday evening the conference will be opened officially. After the Opening Ceremony we invite all participants to our Get Together in the Gürzenich Conference Center. This event will also enable members of the scientific and medical community to get to know their colleagues over a drink and snack.



Leisure and Cultural Activities

The *Gürzenich Conference Center* is situated right in the heart of Cologne, an ideal location to explore all the different facets of one of the liveliest towns in Germany.

The Conference Site: Since its completion in 1447, the Gürzenich was the largest secular building of the city from the middle ages, with its Gothic façade and its turret-framed roof. It was used to receive the most important guests including Kings and Queens. Major reconstruction followed in the 19th century.

Walking around the Old Town: Located between the lovely Rhine embankment promenade and the cathedral the old town offers fresh air and nice walks. To get a bird-eye-view of the town you might wish to climb the cathedral tower. The *Farina House* just across the Gürzenich is the birthplace of *Eau de Cologne*. It portrays a particular section of Cologne's economic and social history via the perfume industry. Walking a bit further along the Rhine you will see a shiny glass building extending into the river. It houses the unique *Chocolate Museum* – a very nice place to relax.



Culture: Both, an architectural and a cultural highlight is the *Kolumba*, the art museum of the archbishopric of Cologne. The fascinating new building was designed by *Peter Zumthor* and houses an impressive collection of art from late antiquity to the present. A place you also shouldn't miss is the *Museum Ludwig* where you can find one of the most distinguished collections of 20th century art ranging from Russian avant-garde to works of famous contemporary artists.

Beer Culture: The place to dive into the town's beer culture is *Brauhaus Früh*. If you prefer a smaller cosier place you could try *Altstadt Päßgen* – both places offer hefty meals well suited before a round of beer.

Shopping: The main shopping streets are *Schildergasse* and *Hohe Straße*. If you are looking for a smaller exclusive choice we recommend the *Mittelstraße*. In Germany shops do not open Sundays however the shopping arcade at the train station is open 7 days a week.



08:30 – 12:00 | ROOM: GROSSER SAAL

Hematology Educational

Chairs: Martin Dreyling (Munich, DE),
Anton Hagenbeek (Amsterdam, NL)

A faculty of renowned international experts will present standard of care and recent advances in the management of other lymphoma and chronic leukemias.

Topic	Speaker
08:30 – 08:35 Introduction	Martin Dreyling (Munich, DE), Anton Hagenbeek (Amsterdam, NL)
08:35 – 09:10 Chronic Lymphocytic Leukemia (CLL)	Michael Hallek (Cologne, DE)
09:10 – 09:45 Mantle Cell Lymphoma (MCL)	Martin Dreyling (Munich, DE)
09:45 – 10:20 Aggressive Non-Hodgkin Lymphoma	Wyndham Wilson (Bethesda / MD, US)
10:20 – 10:50 Coffee break	
10:50 – 11:25 Follicular Lymphoma (FL)	Anton Hagenbeek (Amsterdam, NL)
11:25 – 12:00 Multiple Myeloma (MM)	Maria-Victoria Mateos (Salamanca, ES)

Workshops

Workshop 1 (parallel sessions) 09:00–10:30

New Concepts of Radiation Field Design, Advanced Technologies and New Normal Organ Constraints

ROOM: ISABELLENSAAL

Richard Hoppe (Stanford, US), Joachim Yahalom (New York, US)

Radiation field reduction beyond ISRT? – options and concerns	George Mikhaeel (London, UK)
Avoidance of organs at risk / dose-volume constraints – deep inspiration breath hold: techniques and daily monitoring	David Hodgson (Toronto, CA)
Avoidance of organs at risk / dose-volume constraints – dose / volume constraints for key organs at risk	Berthe Aleman (Amsterdam, NL)

Workshop 2 (parallel sessions) 09:00–10:30

Epidemiology and Registry Data

ROOM: KLEINER SAAL

Magnus Björkholm (Stockholm, SE), Nelson Spector (Rio de Janeiro, BR)

Welcome and short introduction	Nelson Spector (Rio de Janeiro, BR), Magnus Björkholm (Stockholm, SE)
Experience from the international T cell project	Massimo Federico (Modena, IT)
Registry studies on Hodgkin Lymphoma – the US experience	Rahul Parikh (New Brunswick, US)
Registry-based studies on socio-economic impact on outcome in Hodgkin Lymphoma in Brazil	Irene Biasoli (Rio de Janeiro, BR)
Registry-based studies on pregnancy in Hodgkin Lymphoma patients	Caroline Weibull (Stockholm, SE)
Registry-based research – pros and cons – the statistician's view	Paul Dickman (Stockholm, SE)
General discussion	

Workshop 3 (parallel sessions) 10:45–12:15**Pathology and Pathogenesis** ROOM: ISABELLENSAAL

Anke van den Berg (Groningen, NL), Andreas Rosenwald (Würzburg, DE)

Risk and prognosis in Hodgkin Lymphoma and associations with an active, innate or anergic tumor immune response
Ingrid Glimelius (Stockholm, SE)NF-KB / IRF5 in Hodgkin Lymphoma
Stefan Mathas (Berlin, DE)Noncoding RNAs and microRNA in Hodgkin Lymphoma
Joost Kluiver (Groningen, NL)**Workshop 4 (parallel sessions) 10:45–12:15****PET** ROOM: KLEINER SAAL

Bruce Cheson (Washington D.C., US), Martin Hutchings (Copenhagen, DK)

Pretreatment stage or metabolic volume: which is better to direct treatment strategy?
Michel Meignan (Créteil, FR)Response assessment in the era of checkpoint inhibitors
Philippe Armand (Boston, US)**Satellite Symposium (Celgene) 12:45–13:45****Recent Advances in the Treatment of Lymphoma**

ROOM: GROSSER SAAL

Andreas Engert (Cologne, DE)

The FLASH project: establishing a novel surrogate endpoint in first-line FL
Wolfgang Hiddemann (Munich, DE)Update on clinical data of IMiDs® in the treatment of lymphoma
Pier Luigi Zinzani (Bologna, IT)**Workshop 5 (parallel sessions) 14:00–15:30****Biomarkers** ROOM: GROSSER SAAL

Christian Steidl (Vancouver, CA), Bastian von Tresckow (Cologne, DE)

Methodological issues of circulating cell-free DNA detection in HL
Peter Vandenberghe (Leuven, BE)Outcome prediction of aSCT using Hodgkin Lymphoma relapse biopsies
Fong Chun Chan (Vancouver, CA)Nanostring-based outcome prediction in HL patients treated with BEACOPP
Andreas Rosenwald (Würzburg, DE)Integration of IPS factors with gene expression for treatment outcome prediction
Catherine S. Diefenbach (New York, US)Biomarkers / companion diagnostics for checkpoint inhibition
Steven Ansell (Rochester, US)**Workshop 6 (parallel sessions) 14:00–15:30****Elderly Patients** ROOM: KLEINER SAAL

Boris Böll (Cologne, DE), Jonathan Friedberg (Rochester, US)

US experience in elderly HL
Andrew Evens (Boston, US)European experience in elderly HL
Marc André (Yvoir, BE)Geriatric assessment
Ulrich Wedding (Jena, DE)Trials on Brentuximab Vedotin and checkpoint inhibitors in elderly HL
Jonathan Friedberg (Rochester, US)Population based data on elderly HL
Magnus Björkholm (Stockholm, SE)**Workshop 7 (parallel sessions) 14:00–15:30****GHSB Workshop** ROOM: ISABELLENSAAL

Andreas Engert (Cologne, DE), Michael Fuchs (Cologne, DE)

GHSB participants only. Workshop language German.

Workshop 8 (parallel sessions) 16:00–17:30**Genetics and Microenvironment** ROOM: GROSSER SAAL

Ralf Küppers (Essen, DE), Margaret Shipp (Boston, US)

Molecular pathogenesis of NLPHL
Sylvia Hartmann (Frankfurt / Main, DE)The B cell receptor specificity of LP cells in NLPHL
Lorenz Thurner (Homburg / Saar, DE)P026 Hodgkin cell-derived extracellular vesicles shape fibroblast activity
Teresa Bösl (Cologne, DE)P030 The lymphoid cell specific transcription factor ELF-1 is downregulated and deleted in classical Hodgkin lymphoma
Maciej Giefing (Poznan, PL)P036 Tightly regulated FOXO3 expression is critical for the maintenance of cHL
Clarissa Weitzer (Ulm, DE)**Workshop 9 (parallel sessions) 16:00–17:30****NLPHL** ROOM: ISABELLENSAAL

Joseph Connors (Vancouver, CA), Andreas Engert (Cologne, DE)

Update on classification of NLPHL and its distinction from TCRBCL and transformed DLBCL
Nancy L. Harris (Boston, US)Latest GHSB data on NLPHL
Dennis Eichenauer (Cologne, DE)Case studies of patients with "apparent" relapse of NLPHL
Joseph Connors (Vancouver, CA)

Workshop 10 (parallel sessions)**16:00–17:30****Late Effects** ROOM: KLEINER SAAL

Lena Specht (Copenhagen, DK), Flora van Leeuwen (Amsterdam, NL)

Influence of radiotherapy and chemotherapy in modern Hodgkin Lymphoma treatment on risks of cardiovascular disease and second malignancy
Lena Specht (Copenhagen, DK)

Reducing cardiovascular risk in Hodgkin Lymphoma survivors – the SECURE trial
John Radford (Manchester, UK)

Phase 2 trial comparing the feasibility and efficacy of physical activity and multifactorial drug treatment in Hodgkin Lymphoma survivors
Flora van Leeuwen (Amsterdam, NL)

Satellite Symposium (Novartis)**17:45–19:15****Into the Future – New Treatment Options for Hematologic Malignancies** ROOM: GROSSER SAAL

Peter Borchmann (Cologne, DE)

17:45–17:50
Welcome
Peter Borchmann (Cologne, DE)

17:50–18:05
Midostaurin – a novel therapeutic approach for patients with FLT3-mutated AML
Thomas Fischer (Magdeburg, DE)

18:05–18:20
The concept of treatment-free remission in CML – results from current studies
Alexander Kiani (Bayreuth, DE)

18:20–18:35
Panobinostat for relapsed or refractory myeloma: pan-HDAC-inhibition with epigenetic effects
Andreas Günther (Kiel, DE)

18:35–19:15
Advances in the treatment of hematologic malignancies: use of CAR T cells
Peter Borchmann (Cologne, DE)

Sunday, 23.10.2016**Satellite Symposium (Mundipharma EDO)****07:30–08:30****The Evolution of Chemotherapy: Using the A-DAC Principle to Unlock New Treatment Options in Hodgkin Lymphoma** ROOM: GROSSER SAAL

Volker Diehl (Cologne, DE)

07:30–07:35
The evolution of chemotherapy – an introduction from the chair
Volker Diehl (Cologne, DE)

07:35–07:45
The A-DAC principle – introducing EDO-S101
Volker Diehl (Cologne, DE)

07:45–08:05
Breaking through resistance – the potential for EDO-S101 (an overview of pre-clinical data in Hodgkin Lymphoma)
Antonello Pinto (Naples, IT)

08:05–08:25
EDO-S101: pre-clinical data in Multiple Myeloma and initial findings from phase I in haematological malignancies
Christoph Driessen (St. Gallen, CH)

08:25–08:30
Unlocking the potential – Q&A session
Volker Diehl (Cologne, DE)

Scientific Session 1**08:30–10:00****Interactive Case Discussions** ROOM: GROSSER SAAL

Faculty: Peter Borchmann (Cologne, DE), Richard Hoppe (Stanford, US), John Raemaekers (Nijmegen, NL)
Presenters: Marc André (Yvoir, BE), Ranjana Advani (Stanford, US), Paul Bröckelmann (Cologne, DE), Mark Hertzberg (Randwick, AU)

Presentation of difficult and controversial Hodgkin Lymphoma cases with a focus on interaction and discussion

1. Early unfavorable (PET-driven treatment?)
2. Pregnancy advanced stage
3. Very late relapse
4. CR with PD1 in R&R

Scientific Session 2**10:30–12:00****MRD and Prediction** ROOM: GROSSER SAAL

Michel Meignan (Créteil, FR), Pier Luigi Zinzani (Bologna, IT)

10:30–10:50
Clinical – IPS and other scores Jonathan Friedberg (Rochester, US)

10:50–11:10
Serum marker Arjan Diepstra (Groningen, NL)

11:10–11:30
Circulating cell-free DNA in HL Peter Vandenberghe (Leuven, BE)

11:30–11:40 | T013
Plasma vesicle-associated miRNAs as therapy response biomarkers in Hodgkin Lymphoma, *Michiel Pegtel (Amsterdam, NL)*

11:40–11:50 | T014
Mid-treatment TARC and mid-treatment FDG-PET predict for progression free survival in classical Hodgkin Lymphoma, *Wouter Plattel (Groningen, NL)*

11:50–12:00 | T015
A comprehensive analysis of Hodgkin Lymphoma seasonality across various geographic regions, *Sven Borchmann (Cologne, DE)*

Lunch Symposium (Amgen)**12:15–13:45****New Insights in the Treatment and Management of Lymphoid Malignancies** ROOM: GROSSER SAAL

Maria-Victoria Mateos (Salamanca, ES)

12:15–12:20
Welcome Maria-Victoria Mateos (Salamanca, ES)

12:20–12:45
Impact of febrile neutropenia in the HD18 trial: final analysis of the project “daily G-CSF versus Pegfilgrastim” Peter Borchmann (Cologne, DE)

12:45–13:15
BiTE®: a new strategy for hematologic malignancies Nicola Gökbuget (Frankfurt, DE)

13:15–13:45
Multiple Myeloma: new treatment options for patients with Carfilzomib Maria-Victoria Mateos (Salamanca, ES)

13:45
Conclusion and closing remarks Maria-Victoria Mateos (Salamanca, ES)

Workshop 11 (parallel sessions)**14:00–15:30****Immunomodulation** ROOM: KLEINER SAAL

Philippe Armand (Boston, US), Tim Illidge (Manchester, UK)

Biological basis for PD-1 based immunotherapy Marit Roemer (Boston / MA, US)

How do we rationally combine immune checkpoint therapy for optimal impact Steven Ansell (Rochester, US)

Radiotherapy and immunotherapy combinations Tim Illidge (Manchester, UK)

Allo transplant vs checkpoint blockade in HL Philippe Armand (Boston, US)

Workshop 12 (parallel sessions)**14:00–15:30****Current Concepts in Allo TX** ROOM: GROSSER SAAL

Anton Hagenbeek (Amsterdam, NL), Anna Sureda (Barcelona, ES)

Allo-SCT in RR HL. The state of the art Norbert Schmitz (Hamburg, DE)

The impact of the stem cell source (HLA id Sib vs MUD vs CB vs Haplo) in the outcome after allo-SCT Luca Castagna (Milan, IT)

The role of allogeneic stem cell transplantation in the era of new drugs Anna Sureda (Barcelona, ES)

Workshop 13 (parallel sessions)**14:00–15:30****Grey Zone Lymphoma** ROOM: MARSILIUSSAAL

Jonathan Friedberg (Rochester, US), Wyndham Wilson (Bethesda / MD, US)

Pathology of grey zone lymphomas Stefania Pittaluga (Bethesda / MD, US)

P065 Joint pediatric Hodgkin and Non-Hodgkin lymphoma study group on grey zone lymphoma in children and adolescents Christine Mauz-Körholz (Gießen, DE)

Retrospective study of grey zone lymphomas Andrew Evens (Boston, US)

Mediastinal grey zone lymphomas: are they more like PMBL or nsHL? Wyndham Wilson (Bethesda / MD, US)

Satellite Symposium 16:00–17:30 (prIME Oncology, supported by Takeda Oncology)

Relapsed / Refractory Hodgkin Lymphoma: Nuances in Therapeutic Strategies to Improve Outcomes – a Case-Based Program

Andreas Engert (Cologne, DE) **ROOM: GROSSER SAAL**

Welcome and introduction Andreas Engert (Cologne, DE)

16:00–16:10

Avoiding relapse of Hodgkin Lymphoma (HL):
have we moved the needle? Andreas Engert (Cologne, DE)

16:10–16:15

Case #1: patient with advanced HL who
relapses 18 months after initial therapy Pier Luigi Zinzani
(Bologna, IT)

16:15–16:30

Relapsed / refractory HL: therapeutic options
prior to autologous stem cell transplant (ASCT) Pier Luigi Zinzani
(Bologna, IT)

16:30–16:35

Case #2: patient with bulky relapsed HL
occurring 10 months following initial therapy Craig Moskowitz
(New York, US)

16:35–16:50

Post-ASCT relapse: making the most of what
we have Craig Moskowitz
(New York, US)

16:50–16:55 Q&A

16:55–17:00

Case #3: patient with HL who has relapsed
following ASCT Timothy Illidge
(Manchester, UK)

17:00–17:15

Novel agents in HL: what, how, and when
should they be integrated? Timothy Illidge
(Manchester, UK)

17:15–17:25

Challenge the experts Entire faculty panel

17:25–17:30

prIME Points™ Andreas Engert (Cologne, DE)



Opening Ceremony

Gürzenich Congress Center

17:45–19:45

Key Note Lecture **ROOM: GROSSER SAAL**

Awards Ceremony **ROOM: GROSSER SAAL**

Get Together

Gürzenich Congress Center

20:00

GÜRZENICH

Monday, 24.10.2016
**Satellite Symposium
(Janssen-Cilag)**
07:30–08:30
Future Directions in Lymphoma and Myeloma Therapy

 Barbara Eichhorst (Cologne, DE) **ROOM: GROSSER SAAL**
08:30–08:50

Mode of action of PD1 / PD-L1 monoclonal antibodies in HL Peter Hillmen (Leeds, UK)

08:50–09:10

Novel therapeutic strategies to improve outcome of patients with aggressive lymphomas Georg Lenz (Münster, DE)

09:10–09:30

Targeting CD38 in Multiple Myeloma Christof Scheid (Cologne, DE)

Session 3
08:30–10:00
Biology and Microenvironment **ROOM: GROSSER SAAL**

Stephan Mathas (Berlin, DE), Margaret Shipp (Boston, US)

08:30–08:50

Genetic lesions in HRS cells and their relationship to CD30+ B cells Ralf Küppers (Essen, DE)

08:50–09:10

Exome-sequencing in HL Enrico Tiacci (Perugia, IT)

09:10–09:30

Gene expression profiling of the HL microenvironment Christian Steidl (Vancouver, CA)

09:30–09:40 | T004

 Analysis of the mutational landscape and dynamics in Hodgkin Lymphoma using NGS, *Juan F Garcia (Madrid, ES)*
09:40–09:50 | T005

 High expression of programmed cell death receptor 1 (PD-1) in the tumor microenvironment is associated with inferior event free survival in classical Hodgkin Lymphoma, *Peter Hollander (Uppsala, SE)*
09:50–10:00 | T006

 The AP-1 transcription factor BATF3 regulates MYC expression and is required for tumor cell survival in classical Hodgkin Lymphoma and anaplastic large cell lymphoma, *Anna Lollies (Essen, DE)*
Session 4
10:30–12:00
Immunotherapy (Basic Science) **ROOM: GROSSER SAAL**

Alison Moskowitz (New York, US), Harald Stein (Berlin, DE)

10:30–10:50

PD1 / PD-L1 / L2 assessment in HL

Margaret Shipp (Boston, US)

10:50–11:10

Mode of action of PD1 / PD-L1 MoAbs in HL

Alison Moskowitz (New York, US)

11:10–11:30

Other new approaches

Anke van den Berg (Groningen, NL)

11:30–11:40 | T007

 Hodgkin Lymphoma infiltrating T cells: considering various means of tumor evasion, *Frederik Wein (Essen, DE)*
11:40–11:50 | T008

 CCR5 blocking by Maraviroc inhibited recruitment, proliferation and pro-tumor effects of mesenchymal stromal cells and monocytes in 2D and 3D models of Hodgkin Lymphoma microenvironment *Naike Casagrande (Aviano, IT)*
11:50–12:00 | T009

 Disturbed antigen presentation in classical Hodgkin Lymphoma: implications for immune checkpoint inhibitor therapy? *Arjan Diepstra (Groningen, NL)*
**Lunch Symposium
(Bristol-Myers Squibb)**
12:15–13:45
Evolving Therapy in the HL Treatment Landscape

 Andreas Engert (Cologne, DE) **ROOM: GROSSER SAAL**
12:15–12:20

Welcome and introductions

Andreas Engert (Cologne, DE)

12:20–12:45

Rationale for I-0 therapies in solid and hematological malignancies

Andreas Mackensen (Erlangen, DE)

12:45–13:10

Balancing the risk-benefit ratio: current treatment regimens and unmet needs in HL

Andreas Engert (Cologne, DE)

13:10–13:35

I-0 in cHL: an eye towards the future

Michelle Fanale (Houston, US)

13:35–13:45

Audience Q&A session conclusions

Andreas Engert (Cologne, DE)

Session 5

14:00–15:30

PET – Where Are We? ROOM: GROSSER SAAL

Markus Dietlein (Cologne, DE), John Radford (Manchester, UK)

14:00–14:20
PET update 2016
Bruce Cheson
(Washington D.C., US)

14:20–14:40
WS report “Is PET as good as we think?”
Michel Meignan (Créteil, FR)

14:40–15:00
Visual and quantitative PET/CT
Carsten Kobe (Cologne, DE)

15:00–15:10 | T019

Only focal bone marrow FDG uptake in baseline FDG–PET scan has a diagnostic and prognostic impact in Hodgkin Lymphoma: results from an international collaborative study, *Colette Zwarthoed (Nice, FR)*

15:10–15:20 | T020

Strong predictive value of PET based metabolic tumor volume on survival after autologous HCT for Hodgkin Lymphoma, *Vit Prochazka (Olomouc, CZ)*

15:20–15:30 | T021

Semi-quantitative parameters to improve the interim FDG–PET/CT positive predictive value in Hodgkin Lymphoma, *Annarosa Cuccaro (Rome, IT)*

Session 6

16:00–17:30

Early Stages ROOM: GROSSER SAAL

Hans Theodor Eich (Münster, DE), Andrew Lister (London, UK)

16:00–16:20
Early favorable HL: pros and cons of PET-adapted therapy
Martin Hutchings
(Copenhagen, DK)

16:20–16:40
Early unfavorable: new standard of care?
John Raemaekers
(Nijmegen, NL)

16:40–17:00
NLPHL
Dennis Eichenauer
(Cologne, DE)

17:00–17:10 | T010

Long-term follow-up of contemporary treatment in early-stage favorable Hodgkin Lymphoma (HL): updated analyses of the German Hodgkin Study Group HD7 and HD10 trial, *Stephanie Sasse (Cologne, DE)*

17:10–17:20 | T011

Proton radiotherapy for mediastinal Hodgkin Lymphoma: single institution experience, *Katerina Dedeckova (Prague, CZ)*

17:20–17:30 | T012

Results of US intergroup trial of response-adapted chemotherapy or chemotherapy / radiation therapy based on PET for non-bulky stage I and II Hodgkin Lymphoma (HL) (CALGB / Alliance 50604), *David Straus (New York, US)*

Dinner Symposium
(Medscape Education Symposium)

17:45–19:15

Managing Hodgkin Lymphoma – A World View

ROOM: GROSSER SAAL Andreas Engert (Cologne, DE)

Welcome and introduction
Andreas Engert (Cologne, DE)

Diagnostics in practice: the ideal and the pragmatic
Raymond H. S. Liang
(Hong Kong, CN)

Prognostic indicators in front-line HL: a practical guide to individualizing therapy
Joseph Connors
(Vancouver, CA)

Imaging and monitoring strategies: optimizing available resources
Astrid Pavlovsky
(Buenos Aires, AR)

Optimizing HL management in the relapsed / refractory setting: making the most of available options
Andreas Engert (Cologne, DE)

Concluding remarks
Andreas Engert (Cologne, DE)

Tuesday, 25.10.2016

Satellite Symposium
(Bristol-Myers Squibb)

07:30–08:30

Ask the Expert: An Open Forum on Hodgkin Lymphoma

ROOM: GROSSER SAAL

Moderator Philippe Armand (Boston, US)

Panelists

- Craig Moskowitz (New York, US)
- Graham Collins (Oxford, UK)
- Catherine S. Diefenbach (New York, US)
- Vincent Ribrag (Villejuif, FR)

Program Description This session will serve as a forum to share expert perspectives by addressing key questions presented by audience members on various aspects of Hodgkin lymphoma, including early phases of research to clinical management. Audience participation will be encouraged to help drive the discussion among the panelists.

Session 7

08:30–10:00

Pediatric HL ROOM: GROSSER SAAL

Christine Mauz-Körholz (Gießen, DE), Nelson Spector (Rio de Janeiro, BR)

08:30–08:50
Interim results of EuroNet-PHL-C1
Judith Landman-Parker (Paris, FR)

08:50–09:10
Targeted agents in pediatric HL
Monika Metzger (Memphis, US)

09:10–09:30
COG / ECOG: AYA HL
Kara Kelly (New York, US)

09:30–09:40 | T016

Whole body functional and anatomical MRI: accuracy in staging and treatment response monitoring in childhood and adolescent Hodgkin's Lymphoma compared to conventional multimodality imaging (CRUK C23580/A12707), *Stephen Daw (London, UK)*

09:40–09:50 | T017

Phase III study of response adapted therapy for the treatment of children with newly diagnosed very high risk Hodgkin Lymphoma (Stages IIIB/IVB) (AHOD0831): a report from the Children's Oncology Group
Kara Kelly (Buffalo, US)

09:50–10:00 | T018

Outcomes in adolescents and young adults (AYA) with Hodgkin Lymphoma (HL) treated on US cooperative group protocols: an adult intergroup (E2496) and Children's Oncology Group (COG AHOD0031) comparative analysis
Tara Henderson (Chicago, US)

Session 8

10:30–12:00

Advanced Stages ROOM: GROSSER SAAL

Massimo Federico (Modena, IT), Volker Diehl (Cologne, DE)

10:30–11:10
Debate: PET-guided ABVD versus old school
BEACOPP: Peter Johnson (Southampton, UK),
Peter Borchmann (Cologne, DE)
Moderator:
Anton Hagenbeek (Amsterdam, NL)

11:10–11:30
Perspectives in advanced HL
Pauline Brice (Paris, FR)

11:30–11:40 | T001

BEACOPPescalated followed by radiotherapy of initial bulk or residual disease in advanced-stage Hodgkin Lymphoma: long-term follow-up of the GHSG HD9 and HD12 trials, *Bastian von Tresckow (Cologne, DE)*

11:40–11:50 | T002

Overall survival (OS) impact of BEACOPP versus ABVD in advanced Hodgkin Lymphoma: a pooled analysis of 4 randomized trials, *Marc André (Yvoir, BE)*

11:50–12:00 | T003

Long-term follow-up of SWOG S0816: response-adapted therapy of advanced stage Hodgkin Lymphoma using early interim FDG-PET imaging, *Jonathan Friedberg (Rochester, US)*

Lunch Symposium
(Roche)

12:15–13:00

Classification of New Therapeutic Options for CLL and Follicular NHL ROOM: GROSSER SAAL

Kai Hübel (Cologne, DE)

12:15–12:35
Chronic Lymphocytic Leukemia
Clemens Wendtner (Munich, DE)

12:35–13:00
Relapsed Follicular Non-Hodgkin Lymphoma
Kai Hübel (Cologne, DE)

**Poster Walk** GÜRZENICH, KLEINER SAAL

13:00–13:45

Please join the poster presentation and take the chance to discuss the results with your colleagues.

Session 9

14:00–15:30

Relapsed HL ROOM: GROSSER SAAL

Pauline Brice (Paris, FR), Andreas Engert (Cologne, DE)

14:00–14:20
Brentuximab vedotin in relapsed HL
Craig Moskowitz (New York, US)

14:20–14:40
Clinical results with anti-PD(L)1 antibodies in HL
Philippe Armand (Boston, US)

14:40–15:00
Role of allo-Tx in the PD1 era
Franck Morschhauser (Lille, FR)

15:00–15:10 | T022

CheckMate 205 cohort C: Nivolumab in patients with classical Hodgkin Lymphoma after prior Brentuximab Vedotin and autologous hematopoietic stem cell transplantation, *Pier Luigi Zinzani (Bologna, IT)*

15:10–15:20 | T023

Pembrolizumab for relapsed / refractory classical Hodgkin Lymphoma (R/R cHL): multicohort, phase 2 KEYNOTE-087 study, *Craig Moskowitz (New York, US)*

15:20–15:30 | T024

TRANSPLANT BraVe: combining Brentuximab Vedotin with DHAP as salvage treatment in relapsed / refractory Hodgkin Lymphoma (HL). A phase 1 dose-escalation study, *Anton Hagenbeek (Amsterdam, NL)*



Session 10

16:00–17:30

Survivorship ROOM: GROSSER SAAL

Flora van Leeuwen (Amsterdam, NL), Peter Borchmann (Cologne, DE)

16:00–16:20

Fatigue

Stefanie Kreissl
(Cologne, DE)

16:20–16:40

Survivorship surveillance

Alexander Fossa (Oslo, NO)

16:40–17:00

Second malignancies

Flora van Leeuwen
(Amsterdam, NL)

17:00–17:10 | T025

Patient preferences – survey of HL survivors on treatment associated burdens and side effects, *Carolin Bürkle (Cologne, DE)*

17:10–17:20 | T026

Change in peripheral blood lymphocyte telomere length in relation to mortality and morbidity in Hodgkin Lymphoma patients, *Radhia M'kacher (Paris, FR)*

17:20–17:30 | T027

The impact of treatment type and age on ovarian toxicity in the RATHL study, *Richard Anderson (Edinburgh, UK)*

Closing Remarks ROOM: GROSSER SAAL

17:45

Andreas Engert (Cologne, DE)

Abstracts

Oral and Poster Presentations

Posters will be displayed in the “Kleiner Saal” on Monday (October 24) and Tuesday (October 25).

Poster presenters are kindly asked to be present at their poster boards during the Posterwalk on Tuesday, October 25, 13:00 to 13:45 to discuss their research.

1. Biology and Microenvironment

Selected for Oral Presentations

T004

Analysis of the mutational landscape and dynamics in Hodgkin Lymphoma using NGS

Mata E, Díaz-López A, Montalban C, Fernandez R, Bellas C, Burgos F, Mestre MJ, Menárguez J, Provencio M, Santonja C, Piris MA, Garcia JF

T005

High expression of programmed cell death receptor 1 (PD-1) in the tumor microenvironment is associated with inferior event free survival in classical Hodgkin Lymphoma

Hollander P, Peter P, Smedby KE, Enblad G, Mortensen J, Amini RM, d'Amore F, Molin D, Glimelius I

T006

The AP-1 transcription factor BATF3 regulates MYC expression and is required for tumor cell survival in classical Hodgkin Lymphoma and anaplastic large cell lymphoma

Lollies A, Hartmann S, Schneider M, Bracht T, Arnolds J, Klein-Hitpass L, Sitek B, Hansmann ML, Küppers R, Weniger MA

P024

Inactivation of the putative ubiquitin-E3 ligase PDLIM2 in classical Hodgkin and anaplastic large cell lymphoma
Wurster KD, Hummel F, Richter J, Giefing M, Hartmann S, Hansmann ML, Kreher S, Köchert K, Krappmann D, Klapper W, Hummel M, Wenzel S, Lenz G, Janz M, Dörken B, Siebert R, Mathas S

P025

Determination of the mutational landscape of primary Hodgkin and Reed / Sternberg cells of classical Hodgkin lymphoma
Schneider M, Döring C, Czeschik JC, Lollies A, Hartmann S, Rahmann S, Hansmann ML, Küppers R

P026

Hodgkin cell-derived extracellular vesicles shape fibroblast activity
Bösl T, Hansen HP, Engert A, Pogge von Strandmann E

P027

Prognostic implications of an active, innate or anergic immune response in the Hodgkin lymphoma tumor microenvironment
Hollander H, Rostgaard K, Smedby KE, Molin D, Loskog A, de Nully Brown P, Enblad G, Amini RM, Hjalgrim H, Glimelius I

P028

Studying the role of oncogenic miR-24-3p in Hodgkin lymphoma
Yuan Y, Kluive Jr, Koerts J, de Jong D, Rutgers B, Diepstra A, Visser L, van den Berg A

P029

Characterization of Hodgkin lymphoma clonogenic cells using a new L428 in vivo xenograft model in immunodeficient NOD / SCID-gammac-*l*- mice and peripheral lymphocytes study in Hodgkin Lymphoma patients
Cuceu C, Al Jawhari M, Morat L, Frenzel M, Lewandowski D, Junker S, Pflumio F, Bourhis J, Girinsky T, Sabatier L, Carde P, M'kacher R

P030

The lymphoid cell specific transcription factor ELF-1 is transcriptionally downregulated and recurrently deleted in classical Hodgkin lymphoma (cHL)
Giefing M, Zemke N, Bodnar M, Domanowska E, Janiszewska J, Paczkowska J, Ustaszewski A, Martin-Subero JJ, Ammerpohl O, Klapper W, Marszalek A, Siebert R

P031

Mutations in CD58 and MYB in Hodgkin lymphoma
Abdul Razak FR, Diepstra A, Jong D, Koerts J, Rutgers B, Kluiver J, Visser L, van den Berg A

P032

Re-fusion of small mononucleated Hodgkin cells leads to giant multinucleated Reed-Sternberg cells in Hodgkin lymphoma
Rengstl B, Newrzela S, Heinrich T, Weiser C, Thalheimer FB, Schmid B, Warner K, Hartmann S, Schroede Tr, Küppers R, Rieger MA, Hansmann ML

P033

Molecular characterization of Bruton's Tyrosine Kinase Inhibitor in Hodgkin's Lymphoma: Cellular and Animal Models
Muqbil I, Aboukameel A, Azmi AS, Mohammad RM, Ramchandren R

P034

Functional analysis to elucidate the susceptibility mechanisms of SNPs at the REL, GATA3 and TCF3 loci in classical Hodgkin Lymphoma
Veenstra R, Kluiver J, de Jong D, Koerts J, Visser L, Diepstra A, van den Berg A

P035

IGH-mediated translocations, recurrent in classic Hodgkin lymphoma, frequently correlate with an aggressive behavior
Wlodarska I, Dierickx D, Pluys U, Doms K, Graux C, Van Hoof A, Vandenberghe P, Michaux L, Tousseyn T

P036

Tightly regulated FOXO3 expression is critical for the maintenance of cHL

Weitzer CD, Xie L, Guan H, Herrmann F, Pick S, Wirth T, Ushmorov A

P037

In-Vitro and In-Vivo preclinical activity of EDO-S101 in Hodgkin lymphoma

Al Jawhari M, Cuceu C, Frenzel M, Stimmer L, Junker S, Bosq J, Carde P, Mehrling T, Sabatier L, Pflumio F, M'kacher

P038

Hodgkin Reed-Sternberg cells in classical Hodgkin lymphoma are surrounded by T regulatory cells while lymphocyte predominant cells of nodular lymphocyte predominant Hodgkin lymphoma are surrounded by T follicular helper cells

Visser L, Sattarzadeh A, Wu R, Rutgers B, Diepstra A, van den Berg A

P039

The incidence of bleomycin induced lung toxicity is increased in Hodgkin lymphoma patients exposed for granulocyte-colony stimulating growth factor

Andersen MD, Kamper P, d'Amore A, Clausen M, Bentzen H, d'Amore F

P040

Correlation between pre-treatment level of soluble PD-L1 and outcome in classical Hodgkin lymphoma included in a prospective study of the Lymphoma Study Association (LYSA)

Ghesquieres H, Drouet Y, Azzaoui I, Rossille D, Rossi C, Roussel M, Salles G, Traverse-Glehen A, Casasnovas O, Fest T

P041

Proteasome Inhibitor Therapy (PIT) in Hodgkin Lymphoma (HL): Leveraging Systems Biology Analyses (SBA) for Cell-Specific Transcriptome Alterations and Optimum Combinatorial Therapy

Passero Jr. FC, Beheshti A, Dashnamoorthy R, Evens AM

P042

Telomere maintenance mechanisms and Tumor microenvironment are key factors in the outcome of classic Hodgkin lymphoma

M'kacher R, Cuceu C, Morat L, Al Jawhari M, Frenzel M, Shim G, Lenain A, Ricoul M, Hempel W, Guilotto E, Junker S, Girinsky T, Badie C, Colicchio B, Dieterlen A, Jeandidier E, Moralès O, Renaud S, Van de Wyngaert Z, Carde P, Delhem N, Sabatier L

P043

Phenotypic characterization of circulating lymphocytes in Hodgkin's lymphoma (HL) with focus on T cells

Palma M, Heimersson K, Näsman-Glaser B, Hansson L

P044

SIP-F1: A new gray zone lymphoma cell line?

Rengstl B, Hartmann S, Eberth S, Döring C, Pommerenke C, Becker PSA, Weiser C, Warner K, Doering C, Seidl C, Küppers R, Abken H, MacLeod RA, Drexler HG, Hansmann ML, Newrzela S

P045 *withdrawn*

CD4 lymphopenia as a prognosis factor in previously untreated Hodgkin lymphoma

Bogatyreva T, Neprina G, Zamulaeva I, Terekhova A, Smirnova S, Orlova N, Daniliva M, Pavlov V

P046

Can plasma chemokines and soluble receptor monitoring predict outcome in classical Hodgkin's Lymphoma (cHL) patients?

Stamatoullas A, Perdrix A, Lemasle E, Thill C, Camus V, Veresezan L, Picquenot JM, Menard AL, Lenain P, Contentin N, Lanic H, Lepretre S, Brehar O, Cardinael N, Fontura ML, Fronville C, Jardin F, Bastard C, Tilly H

P047

Expression and prognostic impact of indoleamine 2,3-dioxygenase in Hodgkin's lymphoma

Kryachok I, Novosad O, Skrypets T, Ulianchenko K, Tytorenko I, Khranovska N, Skachkova O, Svergun N, Gorbach O

P048

Reed-Sternberg Cells on Bone Marrow Cytology: The Very Early Feature on Hemophagocytic Lymphohistiocytosis Associated to Hodgkin Lymphoma

Niero-Melo L, Lustri LA, Polegatto BF, Del Castanhel C, Cantadori LO, Oliveira CC, Gaiolla RD

P048B

A novel PTPN1 splice variant regulates JAK/STAT activity in classical Hodgkin's lymphoma cells

Zahn M, Marienfeld R, Melzner I, Heinrich J, Rehm A, Barth TF, Dorsch K, Brüderlein S, Möller P

2. Early Stages

Selected for Oral Presentations

T010

Long-term follow-up of contemporary treatment in early-stage favorable Hodgkin Lymphoma (HL): updated analyses of the German Hodgkin Study Group HD7 and HD10 trial

Sasse S, Bröckelmann PJ, Gørgen H, Plütschow A, Mueller H, Kreissl S, Bürkle C, Borchmann S, Fuchs M, Borchmann P, Engert A

T011

Proton radiotherapy for mediastinal Hodgkin Lymphoma: single institution experience

Dedeckova K, Mocikova H, Markova J, Gaheerova L, Kantorova I, Ondrova B, Vondracek V, Vitek P, Kubes J

T012

Results of US intergroup trial of response-adapted chemotherapy or chemotherapy/radiation therapy based on PET for non-bulky stage I and II Hodgkin Lymphoma (HL) (CALGB/Alliance 50604)

Straus DJ, Pitcher B, Kostakoglu L, Grecula JC, Hsi ED, Schoder H, Jung SH, Popplewell LL, Chang JE, Moskowitz CH, Wagner-Johnson N, Leonard JP, Friedberg JW, Kahl BS, Cheson BD, Bartlett NL

Posters

P049

Long-Term Follow-Up of Contemporary Treatment in Early-Stage Unfavorable Hodgkin Lymphoma (HL): Updated Analyses of the German Hodgkin Study Group HD8 and HD11 Trial

Sasse S, Bröckelmann PJ, Gørgen H, Plütschow A, Mueller H, Kreissl S, Bürkle C, Borchmann B, Fuchs M, Borchmann P, Engert A

P050

Final Results of a Quality Assurance Program within the German Hodgkin Study Group HD13/14 trial – A report from the radiotherapy reference panel integrating modern guidelines

Eich HT, Kriz J, Plütschow A, Engenhart-Cabillic R, Haverkamp U, Herfarth K, Lukas P, Schmidberger H, Staar S, Baues C, Fuchs M, Engert A

P051

Clinical outcome of patients with early stage favorable Hodgkin lymphoma treated with ABVD x 2 cycles followed by PET/CT restaging and 20 Gy of involved-site radiotherapy

Kamran SC, Jacene HA, Chen YH, Mauch PM, Ng AK

P052

Optimized "butterfly" VMAT reduces mean dose to coronary arteries for early stage HL patients undergoing mediastinal radiotherapy

Filippi AR, Levis M, Girardi A, Fiandra C, Piva C, Donegani I, Ragona R, Ricardi U

P053

Biological evaluation in the treatment planning. Is there a use for patients with Hodgkin's Lymphoma?

Kriz J, Haverkamp U, Pepper N, Elsayad K, Kröger K, Reinartz G, Glashörster M, Kittel C, Eich HT

P054

The effect of deep inspiration breath hold (DIBH) Intensity-Modulated Radiation Therapy (IMRT) on sparing healthy tissues in the treatment of lymphoma involving the mediastinum
Eastman B, Uhl J, Mosienko V, Murphy J, Sanghvi P

P055

Multicentric Italian Experience in Treatment of Nodular Lymphocyte Predominant Hodgkin Lymphoma (NLPHL) in the Rituximab Era

Gotti M, Merli F, Re A, Rusconi C, Pulsoni A, Rigacci L, Merli M, Liberati M, Ferretti V, Zoboli V, Fama A, Dalceglio D, Meli E, Annechini G, Puccini B, Ferrario A, Appolloni V, Sciarra R, Frigeni M, Arcaini L, Bonfichi M

P056

Construction of a Decision Model to Aid Treatment Choices for Early Stage Hodgkin Lymphoma (ES HL): Bringing Survivorship Forward

Kelly MJ, Parsons SK, Cohen JT, Castellino SM, Kelly KM, Keller F, Henzer TJ, Kumar A, Johnson P, Meyer RM, Morton LM, Radford J, Raemaekers J, Hodgson DC, Evens AM

P057

Doses to organs at risk at different modes of 3D-conformal radiotherapy for mediastinal stage II Hodgkin Lymphoma (HL)
Ilyin NV, Vinogradova JN, Ivanova EI

P058

Residual site radiation therapy (RS RT): An opportunity to increase safety of combined modality therapy (CMT) for early stage Hodgkin lymphoma (HL)

Straus DJ, Cahlon O

1. Advanced Stages

Selected for Oral Presentations

T001

BEACOPP escalated followed by radiotherapy of initial bulk or residual disease in advanced-stage Hodgkin Lymphoma: long-term follow-up of the GHSg HD9 and HD12 trials
von Tresckow B, Kreissl S, Haverkamp H, Sasse S, Diehl V, Engert A, Borchmann P

T002

Overall survival (OS) impact of BEACOPP versus ABVD in advanced Hodgkin Lymphoma: a pooled analysis of 4 randomized trials
André M, Fortpied C, Viviani S, Bellei M, Carde P, Hutchings M, Gianni A, Brice P, Casasnovas O, Gobbi P, Zinzani PL, Dupuis J, Iannitto E, Rambaldi A, Brière J, Perrot A, Heczko M, Valagussa P, Douxfils J, Joubert C, Federico M, Mounier N

T003

Long-term follow-up of SWOG S0816: response-adapted therapy of advanced stage Hodgkin Lymphoma using early interim FDG-PET imaging
Friedberg JW, Li H, Schöder H, Straus DJ, Moskowitz CH, LeBlanc M, Rimsza LM, Bartlett NL, Evens AM, Mitra ES, LaCasce AS, Sweetenham JW, Barr PM, Fanale MA, Knopp MV, Noy A, Hsi ED, Cook JR, Lechowicz MJ, Gascoyne RD, Leonard JP, Kahl BS, Cheson BD, Fisher RI, Press OW

Posters

P001

Sequential Brentuximab Vedotin (BV) and Adriamycin, Vinblastine, and Dacarbazine (AVD) for Older Patients with Untreated Hodgkin Lymphoma (HL): Findings from a Phase II Window Study
Evens AM, Hamlin PA, Nabhan C, Advani RH, Fanale M, Petrich A, Smith SM, Bociek G, Winter J, Gordon LI

P002

Preliminary results of a phase II study of brentuximab vedotin using a response adapted design in the first line treatment of patients with Hodgkin lymphoma unsuitable for chemotherapy due to age, frailty or co-morbidity (BREVITY)

Gibb A, Pirrie S, Linton K, Paterson K, Davies A, Collins G, Menne T, McKay P, Fields P, Miall F, Nagy E, Wheatley K, Warbey V, Barrington S, Radford J

P004

Gray Zone Lymphoma (GZL) with Features Intermediate Between Diffuse Large B-cell Lymphoma (DLBCL) and classical Hodgkin lymphoma (cHL): Diagnostic Experiences and Challenges from a Multicenter Study

Pilichowska M, Pittaluga S, Ferry JA, Hemminger J, Gupta G, Kritharis A, Gascoyne RD, Evens AM, Jaffe ES

P005

Hodgkin lymphoma in Sweden since 2000: better survival only in elderly women – a Swedish Lymphoma Registry study
Engelbrekt Wahlin B, Övergaard N, Peterson S, Digkas E, Glimelius I, Lagerlöf I, Johansson AS, Palma M, Hansson L, Linderöth J, Goldkuhl C, Molin D

P006

Advanced Hodgkin Lymphoma in the East of England Cancer Network: A 10 year comparative analysis of outcomes for ABVD and escalated BEACOPP treated patients aged 16–59
Collins A, Fowler A, Karanth M, Saha C, Russel J, Shyamsundar V, Docherty S, Maw K, Padayatty J, Hodson A, Wimperis J, Sadullah S, Grigoropoulos N, Uttenthal B, Follows G

P007

Superiority of Modified Progression Free Survival (mPFS) to Evaluate Chemotherapy Effectiveness for Advanced Stage Hodgkin Lymphoma
Connors JM, Gerrie AS, Scott DW, Sehn LH, Villa D, Savage KJ

P008

Treatment results for Hodgkin Lymphoma in Brazil: first report from the Brazilian Prospective Hodgkin's Lymphoma Registry
Biasoli I, Castro N, Delamain M, Silveira T, Farley J, Pinto Simões B, Solza C, Praxedes M, Baiocchi O, Gaiolla R, Franceschi F, Bonamin C, Boquimpani C, Clementino N, Perini G, Pagnano K, Steffenello G, Tabacof J, de Freitas Colli G, Soares A, de Souza C, Chiattonne CS, Milito C, Morais JC, Spector N

P009

Dose-Dense / Dose-Intense ABVD (dd-di ABVD) in advanced-stage Hodgkin's Lymphoma (HL): A Long-Term Follow Up Study
Filippo R, Luigi A, Gino S, Pietro F, Secondo L

P010

THE SWITCH FROM ABVD TO eBEACOPP AS FRONT-LINE THERAPY FOR HIGH-RISK STAGE III-IV CLASSICAL HODGKIN LYMPHOMA (cHL) PATIENTS RESULTS IN AN INVERSION OF EVENT-FREE SURVIVAL (EFS) OF PROGNOSTIC GROUPS
Aurer I, Basic-Kinda S, Dujmovic D, Radman I, Dreta B, Dotlic S, Galunic-Bilic L, Dobrenic M, Kralik M, Roncevic P

P011

HALO Study : a phase 1/2 clinical trial of Brentuximab-Vedotin and Bendamustin in elderly patients with previously untreated advanced hodgkin lymphoma. Preliminary data
Viviani S, Fontanet B, Rambaldi A, Perrot A, Patti C, Gastaud L, Sorasio R, Debaigt C, Chamorey E, Gallamini A, Thyss A

P012

Transformation of nodular Hodgkin's lymphoma with lymphocyte predominance to T-cell-rich large B-cell lymphoma
Moiseeva TN, Al-Radi LS, Dorokhina EI, Goryacheva SR, Margolin OV, Magomedova AU, Julhakyhan HL, Kravchenko SK

P013

ABVD AS THE TREATMENT OPTION IN HODGKIN LYMPHOMA WITH LARGE MEDIASTINAL TUMOR

Andjelic B, Jakovic L, Antic D, Todorovic M, Bila J, Djurasinovic V, Sretenovic A, Vukovic V, Jelcic J, Smiljanic M, Mihaljevic B

P014

PERIPHERAL BLOOD EOSINOPHILIA IS A GOOD RISK FACTOR IN POOR PROGNOSIS GROUP: ADVANCED HODGKIN LYMPHOMA WITH LOW ALC/AMC

Jakovic LR, Mihaljevic BS, Andjelic BM, Bogdanovic AD, Perunicic Jovanovic MD, Bumbasirevic VZ

P015

Lower socioeconomic status is associated with shorter survival in HL patients – an analysis from the Brazilian Hodgkin Lymphoma Registry

Biasoli I, Castro N, Delamain M, Silveira T, Farley J, Pinto Simões B, Solza C, Praxedes M, Baiocchi O, Gaiolla R, Franceschi F, Bonamin C, Boquimpani C, Clementino N, Perini G, Pagnano K, Steffenello G, Tabacof J, de Freitas Colli G, Soares A, de Souza C, Chiattonne CS, Raggio R, Milito C, Morais JC, Spector N

P016

THE IMPACT OF OUTCOME OF INTERIM PET/CT ON ADVANCED HODGKIN LYMPHOMA TREATED WITH BEACOPP-14

Medvedovskaya E, Leontjeva A, Demina E, Ryabukhina J, Tumyan G, Kokosadze N, Trofimova O, Larionova V, Dolgushin M, Odzharova A, Mukhortova O, Aslanidis I, Osmanov D

P017

ADVANCED HODGKIN LYMPHOMA – A RISK STRATIFICATION OF ABVD TREATED FEMALES IN GENERATIVE AGE

Andjelic B, Jakovic L, Antic D, Todorovic M, Bila J, Djurasinovic V, Sretenovic A, Vukovic V, Jelcic J, Smiljanic M, Mihaljevic B

P018

ADVANCED STAGE HODGKIN LYMPHOMA IN MOROCCAN ADULTS: CLINICO-PATHOLOGICAL FEATURES AND THERAPEUTIC OUTCOMES

Kaddouri W, Anoun S, Khoubila N, Cherkaoui S, Lamchahab M, Quachouh M, Rachid M, Madani A, Quessar A

P019

General population-derived specific survival applied to Hodgkin Lymphoma

Gobbi PG, Bellei M, Marcheselli L, Chisesi T, Merli F, Galimberti S, Iannitto E, Luminari S, Manni M, Stelitano C, Musto P, Pavone V, Vitolo U, Federico M

P020

The diagnostics and therapy of Hodgkin Lymphoma in pregnancy, the experiences of one center

Gahérová L, Móciková H, Marková J

P021

Difficulties in distinguishing syncytial variant of nodular sclerosis classical Hodgkin's lymphoma from diffuse large B-cell lymphoma and complete remission after intensive chemotherapy

Okatani T, Asaoku H, Fujiwara M, Sato Y, Seto M

P022

Systemic Hodgkin's Disease with osseal involvement

Banti A, Papadakis E, Kioumi A

P023

Brentuximab Vedotin Alone and in Combination With Dacarbazine or Bendamustine in Patients Aged ≥ 60 Years With Newly Diagnosed Hodgkin Lymphoma: Interim Results of a Phase 2 Study

Friedberg JW, Forero-Torres A, Cline-Burkhardt WJM, Bordoni RE, Patel-Donnelly D, Flynn PJ, Chen R, Fong A, Yasenchak CA

4. Immunotherapy (Basic Science)

Selected for Oral Presentations

T007

Hodgkin Lymphoma infiltrating T cells: considering various means of tumor evasion

Wein F, Stock K, Hartmann S, Hansmann ML, Küppers R

T008

CCR5 blocking by Maraviroc inhibited recruitment, proliferation and pro-tumor effects of mesenchymal stromal cells and monocytes in 2D and 3D models of Hodgkin Lymphoma micro-environment

Casagrande N, Borghese C, Celegato M, Aldinucci D

T009

Disturbed antigen presentation in classical Hodgkin Lymphoma: implications for immune checkpoint inhibitor therapy?

Nijland M, Visser L, Veenstra R, Kushekhar K, van Imhoff G, van den Berg A, Diepstra A

Posters**P059**

Tumor infiltrating HLA-matched CD4+ T cells retargeted against Hodgkin and Reed-Sternberg cells

Rengstl B, Schmid F, Weiser C, Döring C, Heinrich T, Warner K, Becker PSA, Wistinghausen R, Kameh-Var S, Werling E, Billmeier A, Seidl C, Hartmann S, Abken H, Küppers R, Hansmann ML, Newrzela S

5. Minimal Residual Disease (MRD) and Prediction

Selected for Oral Presentations**T013**

Plasma vesicle-associated miRNAs as therapy response biomarkers in Hodgkin Lymphoma

Pegtel DM, Drees E, van Eijndhoven MAJ, Groenewegen NJ, van Niele S, Prins R, Baglio SR, van der Voorn H, Libregts SFWM, Wauben MH, de Menezes RX, van Weering JRT, Nieuwland R, Diepstra A, van den Berg A, de Jong D, Zijlstra JM

T014

Mid-treatment TARC and mid-treatment FDG-PET predict for progression free survival in classical Hodgkin Lymphoma

Plattel WJ, van den Berg A, Visser L, Glaudemans A, Diepstra A, van Imhoff GW

T015

A comprehensive analysis of Hodgkin Lymphoma seasonality across various geographic regions

Borchmann S, Müller H, Engert A

Posters**P060**

Evaluation of Serum TARC Levels in Patients at Risk of Progression Following Autologous Stem Cell Transplant for Hodgkin Lymphoma: Results from the AETHERA Trial

Bachanova V, Carella A, Masszi T, Holowiecki J, Viviani S, Huebner D, Hunder N, Larsen E, Odegard J, Onsum M, Moskowitz C

P061

Validation of a clinical / biological prognostic model in a large cohort of elderly patients with a classical Hodgkin lymphoma

Safar V, Morelle M, Brice P, Rossi C, Dupuis J, Perrot A, Stamatoulas A, Garciaz S, Carras S, Lazarovici J, Ghesquieres H

P062

Outcomes and prognostic factors in Hodgkin lymphoma – a single center experience

Pinto A, Mota D, Santos M, Guilherme R, Gomes M, Ribeiro L

P063

Combined prognostic role of TARC protein and PET/CT in patients with Hodgkin lymphoma

Husi K, Illés A, Jóna A, Nagy B, Fejes Z, Barna S, Miltényi Z

6. Pediatric Hodgkin Lymphoma

Selected for Oral Presentations

T016

Whole body functional and anatomical MRI: accuracy in staging and treatment response monitoring in childhood and adolescent Hodgkin's lymphoma compared to conventional multimodality imaging (CRUK C23580 / A12707)

Daw S, Punwani S, Latifoltojar A, Humphries PD, Menezes LJ, Neriman D, Shankar A, Popova B, Smith P, Condne KM, Lopes A, Taylor SA

T017

Phase III study of response adapted therapy for the treatment of children with newly diagnosed very high risk Hodgkin Lymphoma (Stages IIIB / IVB) (AHOD0831): a report from the Children's Oncology Group

Kelly KM, Cole PD, Chen L, Roberts KB, Hodgson DC, McCarten K, Cho SY, Schwartz CL

T018

Outcomes in adolescents and young adults (AYA) with Hodgkin Lymphoma (HL) treated on US cooperative group protocols: an adult intergroup (E2496) and Children's Oncology Group (COG AHOD0031) comparative analysis

Henderson TO, Parsons SK, Wroblewski K, Chen L, Hong F, Smith S, McNeer J, Advani R, Gascoyne RD, Constine LS, Horning S, Bartlett NL, Shah B, Connor JM, Leonard J, Kahl BS, Kelly K, Schwartz CL, Friedman D, Gordon LI, Evens AM

Posters

P065

Joint pediatric Hodgkin and Non-Hodgkin lymphoma study group on grey zone lymphoma in children and adolescents

Burkhardt B, Makarova O, Koerholz D, Zimmermann M, Mueller S, Knoerr F, Oschlies I, Klapper W, Woessmann W, Mauz-Koerholz C

P066

Hodgkin lymphoma in children, adolescents and young adults – a comparative study of clinical presentation and treatment outcome

Englund A, Glimelius I, Rostgaard K, Eloranta S, Molin D, Kuusk T, de Nully Brown P, Kamper P, Smedby KE, Hjalgrim H, Ljungman G, Hjalgrim LL

P067

Pharmacokinetics, Immunogenicity and Safety of Weekly Dosing of Brentuximab Vedotin in Pediatric Patients with Hodgkin Lymphoma

Flerlage J, Metzger M, Panetta JC

P068

Approach and Feasibility of Patient-Reported Outcomes (PROs) in a Phase III clinical trial for advanced stage classical Hodgkin Lymphoma (cHL) in children and adolescents

Castellino SM, Henderson TO, Keller FG, Kelly K, Curtis R, Conti RM, Parsons SK

P069

Prediction of primary treatment response and outcome in pediatric Hodgkin lymphoma using digital gene expression profiling

Mottok A, Johnston RL, Chan FC, Scott DW, Friedman DL, Schwartz CL, Kelly KM, Horton TM, Steidl C

P070

Does involved field radiotherapy improve survival rates in pediatric Classic Hodgkin's Lymphoma?: A retrospective study of 694 children

Zaghoul MS, Akoush H, El Haddad A, Attia E, Taha H, El Wakeel M, Omar W, El Sayed S

P071

CHIPS as a Predictor of Outcome in Radiated vs. Unradiated HL

Schwartz CL, Wolden S, Constine LS, Chen L, Friedman DL

P073

Hodgkin lymphoma (HL) in AYA (adolescents and young adults): Results from a single-tertiary-center prospective cohort of 349 patients

Bigenwald C, Galimard JE, Amorim S, Thieblemont C, Boissel N, Resche-Rigon M, Brice P

P074 *withdrawn*

Prognostic value of 'interim' positron emission tomography among children with Advanced Hodgkin Lymphoma in developing countries; Children Cancer Hospital Egypt experience

Khedr R, Hamouda A, Naguib S, Khalaf M, Fikry S, El Sayed A, Taha H, Zaghloul MS, Attia I

P075

Long-lasting remission in an adolescent with refractory Hodgkin lymphoma after brentuximab vedotin-containing treatment – a case report

Fedorova A, Markavets A, Hushchina L, Aleinikova O

P076

Overview and Survival of Pediatric Advanced stage Hodgkin Lymphoma treated in Developing countries; Children Cancer Hospital Egypt Experience

Hamouda A, Khedr R, Naguib S, Khalaf M, Fikry S, El Sayed A, Taha H, Zaghloul MS, Attia I

7. Positron Emission Tomography (PET)

Selected for Oral Presentations

T019

Only focal bone marrow FDG uptake in baseline FDG-PET scan has a diagnostic and prognostic impact in Hodgkin Lymphoma: results from an international collaborative study

Zwarthoed C, El-Galaly TC, Canepari M, Ouvrier MJ, Ettaiche M, Viviani S, Rigacci L, Trentin L, Rusconi C, Luminari S, Cantonetti M, Bolis S, Borra A, Darcourt J, Salvi F, Subocz E, Tajer J, Kulikowski W, Malkowski B, Zaucha JM, Gallamini A

T020

Strong predictive value of PET based metabolic tumor volume on survival after autologous HCT for Hodgkin Lymphoma

Procházka V, Gawande RR, Cayci Z, Froelich JW, Cao Q, Bachanova V

T021

Semi-quantitative parameters to improve the interim FDG-PET/CT positive predictive value in Hodgkin Lymphoma

Cuccaro A, Annunziata S, Galli E, Bellesi S, D'Alò F, Calcagni ML, Giordano A, Ruffini V, Hohaus S

Posters

P077

The importance of bone marrow ¹⁸F-FDG uptake and focal skeletal lesions on survival in patients with newly diagnosed Hodgkin lymphoma

Pedersen MA, Gormsen LC, Kamper PH, d'Amore A, Enblad G, Molin D, Wassberg C, d'Amore F

P078

INTERIM PET POSITIVITY IN HODGKIN LYMPHOMA: CLINICAL FEATURES AND OUTCOMES

Gaudio F, Perrone T, Sindaco P, Laddaga FE, Pasciolla C, Franco A, Asabella AN, Pedote P, Specchia G

Is FDG-PET the most sensitive tool to diagnose bleomycin induced pneumonitis in Hodgkin's lymphoma?

Öztürk E, Falay O, Bölükbaşı Y, Gümüş T, Örnek S, Özbalak M, Demirkol O, Ferhanoğlu B

8. Relapsed Hodgkin Lymphoma

Selected for Oral Presentations

T022

CheckMate 205 cohort C: Nivolumab in patients with classical Hodgkin Lymphoma after prior Brentuximab Vedotin and autologous hematopoietic stem cell transplantation

Zinzani PL, Engert A, Younes A, Santoro A, Ansell S, Timmerman J, Collins GP, Armand P, Savage KJ, Trneny M, Fanale M, Kuruvilla J, Cohen JB, Shipp M, Rodig S, Kato K, Sumbul A, Farsaci BA, Ratanatharathorn V

T023

Pembrolizumab for relapsed / refractory classical Hodgkin Lymphoma (R/R cHL): Multicohort, phase 2 KEYNOTE-087 study

Moskowitz CH, Zinzani PL, Fanale MA, Armand P, Johnson N, Ribrag V, Radford J, von Tresckow B, Tomita A, Shipp MA, Wang Y, Ricart AD, Balakumaran A, Chen R

T024

TRANSPLANT BRaVE: combining Brentuximab Vedotin with DHAP as salvage treatment in relapsed / refractory Hodgkin Lymphoma (HL). A phase 1 dose-escalation study

Hagenbeek A, Zijlstra JM, Lugtenburg P, van Imhoff GW, Hutchings M, Liu R, Spiering M, van Tinteren H, Kersten MJ

P080

A Phase I Study with an Expansion Cohort of the Combination of Ipilimumab and Brentuximab Vedotin in Patients with Relapsed / Refractory Hodgkin Lymphoma: A trial of the ECOG-ACRIN Cancer Research Group (E4412)

Diefenbach CSM, Hong F, Ambinder RF, Cohen JB, Robertson MJ, Fenske TS, Advani RH, Kahl BS, Ansell SM

P081

Benefit of tandem stem cell transplantation for High Risk relapsed / refractory Hodgkin Lymphoma patients: A French prospective multicenter observational study on 120 patients

Deau B, Amorim S, Perrot A, Quittet P, Cornillon J, Chaoui D, Marolleau JP, Fornecker LM, Robin M, Brice P

P082

Brentuximab Vedotin Plus Bendamustine as a Salvage Treatment Regimen for Patients with Relapsed or Refractory Hodgkin Lymphoma

LaCasce A, Bociek RG, Sawas A, Caimi P, Agura E, Matous J, Ansell S, Crosswell H, Islas-Ohlmayer M, Behler C, Cheung E, Forero-Torres A, Vose J, O'ConnoR OA, Josephson N, Advani R

P083

PET adapted dose escalation of brentuximab vedotin as first line salvage therapy in relapse / refractory HL

Chen R, Palmer J, Herrera A, Chen B, Tsai N, Armenian S, Kennedy N, Cai JL, Nademanee A, Mei M, Kwak L, Rosen S, Forman S

P084

Very Late Relapse (VLR) >5 Years after First Diagnosis of Hodgkin Lymphoma (HL): An Analysis of the German Hodgkin Study Group HD7-HD12 Trials

Bröckelmann PJ, Görgen H, Kohnhorst C, Fuchs M, Borchmann P, Engert A

P085

An International Multicenter Phase I/II Study of Brentuximab Vedotin (BV) and Bendamustine (B) in Patients with Heavily Treated Relapsed or Refractory Hodgkin Lymphoma (HL) and Anaplastic Large T-Cell Lymphoma (ALCL) Demonstrates Marked Durable Responses

O'Connor OA, Sawas A, Connors JM, Turenne I, Rojas C, Lichtenstein R, Deng C, Amengual JE, Villa D, Crump M, Kuruvilla J

P086

Post transplant outcomes in a multicenter phase II study of brentuximab vedotin as first line salvage therapy in relapsed or refractory HL prior to ASCT

Herrera AF, Palmer J, Martin P, Armenian S, Tsai NC, Mott M, Sahebi F, Cai JL, Siddiqi T, Popplewell L, Nademane A, Rosen S, Kwak L, Forman S, Chen R

P087

T cell replete Haploidentical transplantation with post-infusion cyclophosphamide in poor prognosis Hodgkin lymphoma

Castagna L, Bramanti S, Devillier R, Crocchiolo R, Furst S, El Cheikh J, Sarina B, Granata A, Faucher C, Harbi S, Morabito L, Weiller PJ, Chabannon C, Mokart J, Carlo-Stella C, Santoro A, Blaise D

P088

PET-adapted therapy with Brentuximab vedotin (BV) and Augmented ICE for relapsed/refractory Hodgkin lymphoma – Lack of improvement with 3 versus 2 cycles of weekly BV

Moskowitz AJ, Schode Hr, Yahlom J, McCall SJ, Fox SY, Gerecitano J, Grewal R, Hamlin PA, Horwitz S, Kobos R, Kumar A, Matasar M, Noy A, Palomba ML, Merales MA, Portlock CS, Sauter C, Shukla N, Steinherz P, Straus D, Trippett T, Younes A, Zelenetz A, Moskowitz CH

P089

Brentuximab vedotin after autologous stem cell transplant (ASCT) yields the strongest benefit in Hodgkin lymphoma (HL) patients with ≥ 2 risk factors: results of a multivariate analysis (MVA)

Moskowitz C, Sweetenham J, Chen A, Ayala E, Masszi T, Holowiecki J, Stiff P, Carella A, Viviani S, Bachanova V, Sureda A, Huebner D, Lee SY, Hunder N, Thomas L, Uttarwar M, Walewski J

P090

Nivolumab Re-treatment in Patients With Relapsed/Refractory Hodgkin Lymphoma: Safety and Efficacy Outcomes From a Phase 1 Clinical Trial

Ansell SM, Armand P, Timmerman JM, Shipp MA, Mckiver MP, Zhu L, Lesokhin AM

P092

Complete Responses to Immune Checkpoint Inhibitors in Patients with Relapsed or Refractory Hodgkin Lymphoma Previously Treated with 5-Azacytidine: A Possible Role for Epigenetic Priming?

Falchi L, Sawas A, Deng C, Amengual JE, Colbourn DS, Lichtenstein EA, Dials HJ, Khan KA, Schwartz LH, O'Connor OA

P093

Brentuximab Vedotin (BV) in Patients who are Ineligible for Autologous Stem Cell Transplant (ASCT) with Relapsed or Refractory Hodgkin Lymphoma (rrHL): A UK and Germany Retrospective Study

Bröckelmann PJ, Zagadailov EA, Corman S, Hagan M, Chirikov V, Johnson C, Macahilig C, Seal B, Dalal MR, Illidge T

P094

Real-World Effectiveness of Brentuximab Vedotin (BV) vs. Other Treatments in Patients with Relapsed/Refractory Hodgkin Lymphoma (RRHL) post Autologous Stem-Cell Transplantation (ASCT)

Zagadailov EA, Corman SL, Hagan M, Chirikov V, Johnson C, Macahilig C, Seal B, Dalal R, Bröckelmann PJ, Illidge T

P095

Risk Factors (RFs) for Relapse in Patients with Relapsed or Refractory Hodgkin Lymphoma (rrHL) after Autologous Stem Cell Transplant (ASCT): A Real-World Analysis in Germany and the United Kingdom (UK)

Zagadailov EA, Corman SL, Hagan M, Chirikov V, Johnson C, Macahilig C, Seal B, Dalal MR, Illidge T, Bröckelmann PJ

P096

VERY LATE RELAPSES (VLRs) OCCURRING AT LEAST 5 YEARS AFTER THE INITIATION OF TREATMENT WITH CHEMOTHERAPY (CT) OR COMBINED MODALITY THERAPY (CMT) IN PATIENTS WITH HODGKIN (HL): INCIDENCE, RISK FACTORS AND OUTCOME

Vassilakopoulos TP, Pangalis GA, Dimopoulou MN, Siakantaris MP, Dimou M, Boutsikas G, Moschogiannis M, Telonis V, Petevi K, Tzenou T, Yiakoumis X, Kanellopoulos A, Gainaru G, Papageorgiou L, Koutsis K, Asimakopoulos J, Giannakopoulou N, Arapaki M, Dryllis G, Yiannikos T, Konstantinou E, Pessach E, Iliakis T, Sachanas S, Komninaka V, Tsaftaris P, Plata E, Kyrtsionis MC, Tsrkinidis P, Variamis E, Viniou NA, Panayiotidis P, Konstantopoulos K, Angelopoulou MK

P097

Long-term outcome of reduced-intensity allogeneic transplant in relapsed / refractory Hodgkin's lymphoma: the timing of relapse after autologous transplant and primary refractory disease do not impact the long-term survival

Spina F, Dalto S, De Philippis C, Doderò A, Farina L, Montefusco V, Viviani S, Corradini P

P098

The Pharmacokinetic and Pharmacodynamic Properties of Brentuximab Vedotin in a Patient Undergoing Hemodialysis

Liu C, Jang G, Ramchandren R

P099

Immune Systems Engagement Results in Non-Classical Antibody-Drug Conjugate Antitumor Activity of Brentuximab Vedotin

Gardai SJ, Heiser R, Cao A, Li F, Leung-Law C

P100

The long-term outcome of patients with classical Hodgkin Lymphoma (HL) and negative interim PET (iPET) failing ABVD might be worse than that of iPET positive patients undergoing early treatment intensification with escalated BEACOPP

Zauchka JM, Małkowski B, Subocz E, Tajer J, Kulikowski W, Panebianco M, Grad J, Rybka J, Kroll-Balcerzak R, Romanowicz A, Chamier-Ciemńska A, Kurczab P, Cimino G, Chauvie S, Knopinska-Posluszny W, Walewski J, Gallamini A

P101

The value of Brentuximab Vedotin in relapsed / refractory Hodgkin lymphoma patients based on pooled-analysis

Dada R, Zekri J, Bayoumy M, Al Saadi R

P102

A role for allogeneic stem cell transplantation in the era of novel agents for Hodgkin's lymphoma?

Scheid C, Chemnitz J, Herling M, Pflug N, Theurich S, Burst A, Leitzke S, von Bergwelt-Baildon M, Hallek M, Holtick U

P103

Salvage Treatments for Relapsed Classical Hodgkin Lymphoma in Children and Adolescents: a 10-Year Experience in a Single Centre

Fiaccadori V, Roskin J, Sana V, Carpenter B, Hough R, Grandage V, Humphries P, Klusmann M, Menezes L, Daw S

P104

Single-arm study of brentuximab vedotin in patients with relapsed or refractory Hodgkin lymphoma (RRHL) who are ineligible for stem cell transplantation (SCT) or multiagent chemotherapy

Walewski J, Hellmann A, Siritanaratkul N, Ozsan GH, Ozcan M, Chuncharunee S, Goh AS, Jurczak W, Koren J, Wang B, Singh S, Huebner D, Engert A

P105

Outcome of very late relapse in Hodgkin lymphoma – a report from Debrecen, Hungary

Pinczés LI, Miltényi Z, Illés A

P106

LIMITED EFFICACY OF BRENTUXIMAB VEDOTIN (BV) IN A HEAVILY PRE-TREATED HODGKIN LYMPHOMA (HL) POPULATION

Pierdomenico F, Pinto AL, Coutinho J, Chacim S, Raposo J, Neves A, Fevereiro M, Principe F, Vitória MH, Fernandes JP, Carvalho S

P107

The role of stem cell transplantation (SCT) in Hodgkin's disease; perspectives from retrospective analysis

Mazza P, Cascavilla N, Galièni P, Palazzo G, Carella AM, Falcioni S, Pisapia G, Merla E, Amurri B, Angelini S

P108

Autologous Stem cell transplantation in Hodgkin Lymphoma: experience of two centers in Brazil

Sobreira de Almeida J, Pinto MSG, Fortier SC, Bueno da Silveira Rocha TM, Passos RMA, de Lourdes Martins Perobelli L, Chiattonne RR, Chiattonne CS

P109

PD1-Inhibition with Nivolumab after Allogeneic Haematopoietic Cell Transplantation for Hodgkin's Lymphoma

Schulze S, Jaekel N, Monecke A, Leiblein S, Schirmacher P, Niederwieser D, Al-Ali HK

P110

Efficacy of Brentuximab Vedotin in the treatment of relapsed Hodgkin Lymphoma and concomitant Mycosis Fungoides

Meli E, Rusconi C, Zilioli VR, Minga P, Zancanella M, Anghilieri M, Cairoli R

P111

Programmed Death 1 Blockade with Nivolumab as Salvage Therapy for Heavily Pre-treated Classical Hodgkin's Lymphoma Relapsing after Allogeneic Stem Cell Transplantation: A Case Report

Comai A, Domingo-Domenech E, Sureda A

P112

Major response of heavily pretreated Hodgkin lymphoma to Nivolumab: The immune system reloaded

Dada R, Zekri J, Bayoumy M, Al Saadi R

P113

Treatment of a Patient with Primary Refractory Hodgkin Lymphoma and Concurrent Central Nervous System Involvement

Mocikova H, Gaheerova L, Kozak T

P114

Pembrolizumab versus brentuximab vedotin in relapsed or refractory classical Hodgkin lymphoma: randomized, phase 3 KEYNOTE-204 study

Fanale MA, Kline J, Chen R, Ribrag V, Salles G, Matsumura I, Zhu Y, Ricart AD, Balakumaran A, Zinzani PL

9. Survivorship

Selected for Oral Presentations

T025

Patient preferences – survey of HL survivors on treatment associated burdens and side effects

Buerkle C, Goergen H, Müller H, Bröckelmann PJ, Kreissl S, Fuchs M, Engert A, Borchmann P, Behringer K

T026

Change in peripheral blood lymphocyte telomere length in relation to mortality and morbidity in Hodgkin Lymphoma patients

M'kacher R, Girinsky T, Colicchio B, Ricoul M, Dieterlen A, Jeandidier E, Heidingsfelder L, Cuceu C, Bourhis J, Hempel WM, Koscielny S, Paul JF, Sabatier L, Carde P

T027

The impact of treatment type and age on ovarian toxicity in the RATHL study

Anderson RA, Remedios R, Kirkwood AA, Patrick P, Stevens L, Roberts T, Carella AM, Federico M, Fossa A, Hatton C, Kalakonda N, Milligan DW, McKay P, Radford J, Rowntree C, Scott F, Smith P, Johnson PWM

Posters**P115**

Osteonecrosis after treatment for Hodgkin lymphoma: The German Hodgkin Study Group (GHSg) experience
Borchmann S, Müller H, Haverkamp H, Baues C, Marková J, Hüttmann A, Glunz A, Fuchs M, Borchmann P, Engert A

P116

Longitudinal Evaluation of Health-Related Quality of Life (HRQoL) in Hodgkin Lymphoma (HL) Patients and Survivors: Results from the German Hodgkin Study Group (GHSg)
Hude I, Müller H, Görgen H, Bürkle C, Behringer K, Diehl V, Engert A, Borchmann P, on behalf of the German Hodgkin Study Group

P117

Breast cancer after Hodgkin lymphoma: influence of endogenous and exogenous gonadal hormones on the radiation dose-response relationship
Aleman BMP, Krul IM, Opstal-van Winden AWJ, Janus CPM, van Eggermond AM, De Bruin ML, Hauptmann M, Krol ADG, Schaapveld M, Broeks A, Kooijman KR, Fase S, Lybeert ML, Zijlstra JM, van der Maazen RWM, Kesminiene A, Diallo I, De Vathaire F, Russell NS, van Leeuwen FE

P118

Launch of the breast screening after radiotherapy dataset (BARD) – an England wide initiative to improve screening for breast cancer in 9,000 women at high risk following radiotherapy to breast tissue under age 36
Radford J, Howell S, Vaughan K, Goode V, Worthington D, Yates-Bolton N, Payne E, Jenkins J, Sibbering M, Swerdlow A, Cowan R

P119

Managed local follow-up of long term lymphoma survivors – the ADAPT programme
Radford J, Goode V, White E, Monkhouse R, Cowan R

P120

The role of Watch and wait in Nodular Lymphocyte Predominant Hodgkin Lymphoma: single centre data from the modern era
Navarro-Bailón A, Taylor JG, Matthews J, Montoto S, Gribben JG

P121

Neuro-behavioral changes in Hodgkin lymphoma survivors
Trachtenberg E, Mashiach T, Aharon-Peretz J, Dann EJ

P122

Healthcare use among young Hodgkin lymphoma survivors in the era of intensified chemotherapy and limited radiotherapy
Eloranta S, Smedby KE, Ekberg S, Chang ET, Neovius M, Glimelius I

P123

High burden of morbidity from second malignant neoplasms and cardiovascular disease in long-term Hodgkin lymphoma survivors
de Vries S, van Nimwegen FA, Schaapveld M, Lugtenburg PJ, Krol ADG, Roesink JM, Raemaekers JMM, Aleman BMP, van Leeuwen FE

P124

The Impact of Fertility Preservation on Treatment Delay and Progression-Free Survival in Women with Lymphoma: A Single-center Experience

Allen PB, Pavone ME, Smith KN, Kazer RR, Rademaker A, Lawson AK, Moravek MB, Confino R, Gordon LI, Winter JN

P125

Comorbidity assessment using the CIRS in elderly patients with Hodgkin lymphoma: Prediction of Survival

Cuccaro A, Galli E, Maiolo E, Bellesi S, D'Alò F, Hohaus S

P126

Risk adapted ABVD based protocol with restricted radiotherapy to bulky disease for Hodgkin Lymphoma (HL): a 20 year follow up multicenter analysis

Vallansot R, Talarn C, Escoda L, Cervera M, Do Nascimento J, Gumà J, Herranz MJ, Ortin X, Miranda MJ, Martínez F, Prats M, Aguinaco R, Giménez MT, Araguás C, Esteban A, Martínez A, Sarrà J

P127

Infradiaphragmatic Hodgkin Lymphoma: a large series of patients staged with PET-CT. A particular subset of HL?

Rossi C, Mounier M, Brice P, Ghesquières H, Safar V, Nicolas-Virelizier E, Sebban C, Stamatoullas-Bastard A, Alcantara M, Chauchet A, Reboursière E, Filiatre-Légras L, Perrot A, Salles G, Coiffier B, Casasnovas O

P128

A Retrospective Analysis of Fertility in Female Patients with Advanced Stages of Hodgkin Lymphoma Treated with BEACOPP Escalated Chemotherapy (20 Year Experience of a Single Centre)

Marková J, Móciková H, Gaherová Ľ, Jančárková T, Vernerová Z, Dědečková K, Kozák T

P129

Cause-specific mortality among Hodgkin Lymphoma patients up to 40 years after treatment

Schaapveld M, van Eggermond AM, Janus CPM, Krol ADG, Raemaekers JMM, Clevers-Petersen EJ, Lugtenburg PJ, Zijlstra JM, van Imhoff GW, van der Maazen RWM, Roesink JM, Beijert M, Poortmans PMP, Kremer LCM, Louwman MWJ, Lybeert M, de Boer JP, Aleman BMP, van Leeuwen FE

P130

Elderly Hodgkin Lymphoma – Multicenter Retrospective Data Analysis from the Czech Hodgkin Lymphoma Registry

Sýkorová A, Móciková H, Procházka V, Lukášová M, Štěpánková P, Belada D, Klásková K, Gahérová Ľ, Král Z, Martinková L, Nečasová T, Koritáková E, Marková J

P131

Incidence of hyperlipoproteinemia in long-term survivors of Hodgkin lymphoma in childhood or adolescence and in healthy controls

Cepelova M, Jerabkova V, Kruseova J, Stary J, Cepela P, Kraml P

P132

Survivors of adult Hodgkin lymphoma (HL): A frail population. The experience of the survivorship clinic (SC) for adult HL survivors (AHLs) at Istituto Nazionale Tumori of Milan (INT), Italy

Viviani S, Soldarini M, Arendar I, Cieri N, Guidetti A, Busia A, Matteucci P, Gianni AM, Corradini P

P133

Elderly patients with Classical Hodgkin Lymphoma (CHL) have high rates of secondary B-cell non-Hodgkin Lymphoma (NHL)

Gilbertson MG, Hawkes E, Ha-he F, Maclaughlan K, Grigoriadis G, Shortt J, Patil S, Gregory G, Ratnasingham S, Simpson I, Kumar B, Opat S

P134

ANALYSIS OF HODGKIN LYMPHOMA (HL) IN OLDER ADULTS IN A SINGLE CENTER

Cuevas L, Uranga A, López I, Zubicaray I, Robado N, Bizjak AN, Garcia M, Leturia M, Urreta I, Arrizabalaga H, Caminos N, Sirvent M, Perez E, Romero P, Artola T, Lobo C, Araiz M, Ceberio I

P135

An update on BETER, the Dutch nationwide survivorship care programme for Hodgkin lymphoma survivors
Nijdam A, Aleman BMP, van 't Veer MB, Janus CPM, de Weijer R, Daniëls LA, Stedema FG, Zijlstra JM, van der Maazen RWM, Borger JH, Verschueren K, Manenschijn J, Posthuma EFM, Raemaekers JMM, van Leeuwen FE, on behalf of the BETER consortium

P136

Prospective evaluation of pulmonary toxicity in first line treatment of Hodgkin lymphoma patients
Jóna A, Ujj Z, Szilasi M, Pólska S, Bálint BL, Garai I, Miltényi Z, Illés A

P137

Hodgkin lymphoma and pregnancy – dilemmas of how to treat?
Lampka E, Tajer J, Osiadacz W, Brzeska B, Dębska M, Rubach M, Dębski R

P138

Second cancer risks in patients with supradiaphragmatic Hodgkin lymphoma
Shahtarina S, Danilenko A, Pavlov V

P139

Prognostic value of clinical, treatment and socio-demographic results of psychological distress among Hodgkin lymphoma survivors in Hungary
Magyari F, Miltényi Z, Simon Z, Berecz R, Kósa K, Illés A

P140

Hodgkin lymphoma in elderly patients – a single center experience
Santos M, Pinto A, Mota D, Guilherme R, Gomes M, Ribeiro L

P141

Are we aware of nutritional status and vitamin D level in Hodgkin lymphoma patients?
Djurasinovic V, Saric M, Andjelic B, Ignjatovic S, Todorovic Balint M, Antic D, Vukovic, Jelacic J, Sretenovic A, Mihaljevic B

P142

Mental disorders in Hodgkin's disease patients
Vybornykh D, Olexenko L, Khrushchev S, Kravchenko S, Shitareva I, Moiseeva T

P143

Analysis of access time to care for patients with Hodgkin's lymphoma in public hospital in São Paulo
Amaral N, Fisher T, Fortier S, Silveira da Rocha T, Chiattonne CS

P144

The use of coping strategies and social skills in young adult patients with Hodgkin's lymphoma: correlation with anxiety and/or depression symptoms
Silva A, Bruscatto W, Fisher T, Fortier S, Silveira da Rocha T, Chiattonne CS

P145

Quality-of-life (QoL) outcomes in patients (pts) with classical Hodgkin lymphoma (cHL) treated with nivolumab monotherapy in CheckMate 205 (cohort B), a phase (ph) 2 study
Engert A, Hirji I, Taylor F, Bennett B, Cocks K, Kato K, Cella D

Speakers and Chairs

Advani, Ranjana: *radvani@stanford.edu*
Aleman, Berthe: *b.aleman@nki.nl*
Anderson, Richard: *Richard.Anderson@ed.ac.uk*
André, Marc: *marc.andre@uclouvain.be*
Ansell, Stephen: *ansell.stephen@mayo.edu*
Armand, Philippe: *Philippe_Armand@dfci.harvard.edu*
Armitage, James: *joarmita@unmc.edu*
Behringer, Karolin: *karolin.behringer@uk-koeln.de*
Biasoli, Irene: *irene.biasoli@gmail.com*
Björkholm, Magnus: *magnus.bjorkholm@karolinska.se*
Böll, Boris: *boris.boell@uk-koeln.de*
Borchmann, Peter: *peter.borchmann@uni-koeln.de*
Borchmann, Sven: *sven.borchmann@uk-koeln.de*
Bösl, Teresa: *teresa.boesl@uk-koeln.de*
Brice, Pauline: *pauline.brice@sls.aphp.fr*
Bröckelmann, Paul: *paul.broeckelmann@uk-koeln.de*
Bürkle, Carolin: *Carolin.Buerkle@uk-koeln.de*
Casagrande, Naïke: *naïke.casagrande@libero.it*
Castagna, Luca: *luca.castagna@cancercenter.humanitas.it*
Cavalli, Franco: *franco.cavalli@eoc.ch*
Chan, Fong Chun: *fongchunchan@gmail.com*
Cheson, Bruce: *bd4@georgetown.edu*
Coiffier, Bertrand: *bertrand.coiffier@univ-lyon1.fr*
Connors, Joseph: *jconnors@bccancer.bc.ca*
Cuccaro, Annarosa: *annaros.cuccaro@gmail.com*
Dabaja, Bouthaina: *bdabaja@mdanderson.org*
Dann, Eldad J.: *e_dann@rambam.health.gov.il*
Daw, Stephen: *stephen.daw@uclh.nhs.uk*
Dedeckova, Katerina: *katerinarosolova@seznam.cz*
Dickman, Paul: *paul.dickman@ki.se*
Diefenbach, Catherine: *catherine.diefenbach@nyumc.org*
Diehl, Volker: *v.diehl@uni-koeln.de*
Diepstra, Arjan: *a.diepstra@umcg.nl*
Dietlein, Markus: *markus.dietlein@uk-koeln.de*
Dreyling, Martin: *Martin.Dreyling@med.uni-muenchen.de*
Eich, Hans Theodor: *hans.eich@ukmuenster.de*
Eichenauer, Dennis: *dennis.eichenauer@uk-koeln.de*

Engert, Andreas: *a.engert@uni-koeln.de*
Evens, Andrew: *AEvens@tuftsmedicalcenter.org*
Federico, Massimo: *massimo.federico@unimore.it*
Fossa, Alexander: *alexander.fossa@ous-hf.no*
Friedberg, Jonathan: *jonathan_friedberg@urmc.rochester.edu*
Fuchs, Michael: *michael.fuchs@uk-koeln.de*
García, Juan F: *jfgarcia@mdanderson.es*
Gieřng, Maciej: *gieřng@man.poznan.pl*
Glimelius, Ingrid: *ingrid.glimelius@igp.uu.se*
Hagenbeek, Anton: *a.hagenbeek@amc.uva.nl*
Hallek, Michael: *michael.hallek@uni-koeln.de*
Harris, Nancy L.: *nlharris@partners.org*
Hartmann, Sylvia: *s.hartmann@em.uni-frankfurt.de*
Henderson, Tara: *thenderson@uchicago.edu*
Hertzberg, Mark: *mhertzberg10@gmail.com*
Hodgson, David: *David.Hodgson@rmp.uhn.on.ca*
Hollander, Peter: *peter.hollander@igp.uu.se*
Hoppe, Richard: *richard.hoppe@stanford.edu*
Hutchings, Martin: *hutchings@dadlnet.dk*
Illidge, Tim: *Tim.Illidge@ics.manchester.ac.uk*
Johnson, Peter: *johnsonp@soton.ac.uk*
Kelly, Kara: *kara.kelly@roswellpark.org*
Kluiver, Joost: *j.l.kluiver@umcg.nl*
Kobe, Carsten: *carsten.kobe@uk-koeln.de*
Kreissl, Stefanie: *stefanie.kreissl@uk-koeln.de*
Küppers, Ralf: *ralf.kueppers@uk-essen.de*
Landman-Parker, Judith: *judith.landman-parker@aphp.fr*
Lister, Andrew: *a.lister@qmul.ac.uk*
Lollies, Anna: *anna.lollies@uk-essen.de*
M'kacher, Radhia: *radhia.mkacher@gmail.com*
Mateos, Maria-Victoria: *mvmateos@usal.es*
Mathas, Stephan: *stephan.mathas@charite.de*
Mauz-Körholz, Christine: *christine.mauz-koerholz@paediat.med.uni-giessen.de*
Meignan, Michel: *michel.meignan@hmn.aphp.fr*
Metzger, Monika: *Monika.Metzger@STJUDE.ORG*
Mikhaeel, George: *George.Mikhaeel@gstt.nhs.uk*
Morschhauser, Franck: *f-morschhauser@chru-lille.fr*

Moskowitz, Alison J.: *moskowitz@mskcc.org*
Moskowitz, Craig H.: *moskovic@mskcc.org*
Parikh, Rahul: *parikhrr@gmail.com*
Pegtel, Michiel: *d.pegtel@vumc.nl*
Pittaluga, Stefania: *Stefpitt@mail.nih.gov*
Plattel, Wouter: *w.j.plattel@umcg.nl*
Polliack, Aaron: *apol@cc.huji.ac.il*
Prochazka, Vit: *vit.prochazka@fnol.cz*
Radford, John: *John.Radford@manchester.ac.uk*
Raemaekers, John: *J.Raemaekers@hemat.umcn.nl*
Roemer, Marit: *Marit_roemer@dfci.harvard.edu*
Rosenwald, Andreas: *rosenwald@uni-wuerzburg.de*
Sasse, Stephanie: *stephanie.sasse@uk-koeln.de*
Schmitz, Norbert: *n.schmitz@asklepios.com*
Shipp, Margaret: *Margaret_Shipp@dfci.harvard.edu*
Specht, Lena: *specht@rh.dk*
Spector, Nelson: *spector@ufrij.br*
Steidl, Christian: *CSteidl@bccancer.bc.ca*
Stein, Harald: *h.stein@pathodiagnostik.de*
Straus, David: *strausd@mskcc.org*
Sureda, Anna: *asureda@iconcologia.net*
Thurner, Lorenz: *Lorenz.Thurner@uniklinikum-saarland.de*
Tiacci, Enrico: *enrico.tiacci@unipg.it*
van den Berg, Anke: *a.van.den.berg01@umcg.nl*
van Leeuwen, Flora: *f.v.leeuwen@nki.nl*
Vandenbergh, Peter: *peter.vandenbergh@uzleuven.be*
von Tresckow, Bastian: *bastian.von-tresckow@uk-koeln.de*
Wedding, Ulrich: *ulrich.wedding@med.uni-jena.de*
Weibull, Caroline: *caroline.weibull@ki.se*
Wein, Frederik: *frederik.wein@uk-essen.de*
Weitzer, Clarissa: *clarissa.weitzer@uni-ulm.de*
Wilson, Wyndham: *wilsonw@mail.nih.gov*
Yahalom, Joachim: *yahalomj@mskcc.org*
Zinzani, Pier Luigi: *pierluigi.zinzani@unibo.it*
Zwarthoed, Colette: *maracaz@hotmail.fr*

FSA-Kodex

We very much like to thank all of our partners for their generous sponsoring.

According to FSA-Kodex (§ 20 Abs. 5) the following companies asked for information about their financial support:

Name of Sponsor	Total Sponsoring Amount	Sponsoring Benefit
Acromion GmbH	4.000,00 €	Booth
Affimed Therapeutics AG, Heidelberg / Germany		Lanyards
Amgen GmbH, München / Germany	40.000,00 €	
Astra Zeneca GmbH	4.000,00 €	Booth
Bristol-Myers Squibb		
Celgene GmbH	34.000,00 €	Symposium
Chugai Pharma		
Sanofi Genzyme	4.000,00 €	Booth
Hexal AG	4.000,00 €	Booth
Janssen Cilag GmbH		
Managing Hodgkin Lymphoma		
MSD	4.000,00 €	Booth
Takeda Oncology		
Mundipharma EDO GmbH		Symposium
Novartis Pharma GmbH	32.000,00 €	Symposium
primeOncology		
Roche Pharma AG		Silver Sponsor



YOUNG INVESTIGATOR AWARD

Carolin Bürkle (T025)

Wouter Plattel (T014)

Peter Hollander (T005)

Anna Lollies (T006)

Naike Casagrande (T008)

KARL MUSSHOFF PRIZE Best Basic Science Abstract

The Karl Musshoff Foundation was established by Prof. Dr. Karl Musshoff in 1997. The Karl-Musshoff-Prize is granted every three years on the occasion of the ISHL in Cologne for outstanding results in the field of Hodgkin Lymphoma.

This years prize will be awarded to:

ARJAN DIEPSTRA

“Disturbed antigen presentation in classical Hodgkin Lymphoma: implications for immune checkpoint inhibitor therapy?”

KARL MUSSHOFF PRIZE Best Clinical Research Abstract

The Karl Musshoff Foundation was established by Prof. Dr. Karl Musshoff in 1997. The Karl-Musshoff-Prize is granted every three years on the occasion of the ISHL in Cologne for outstanding results in the field of Hodgkin Lymphoma.

This years prize will be awarded to:

PIER LUIGI ZINZANI

“CheckMate 205 cohort C: Nivolumab in patients with classical Hodgkin Lymphoma after prior Brentuximab Vedotin and autologous hematopoietic stem cell transplantation”

CONGRATULATIONS

TO THE GERMAN HODGKIN STUDY GROUP ON THE 10TH ISHL MEETING

Significant milestones have advanced Hodgkin Lymphoma treatment over the past 30 years, due to the contributions of many groups, including the GHSg. Takeda Oncology and Seattle Genetics continue to pioneer new opportunities and partnerships to broadly support research and patient education initiatives.

1980s

ABVD, MOPP & Stanford V are standard FL HL treatment options



1990s

Emergence of BEACOPP as a new therapeutic option

Introduction of involved field radiation in FL HL



2010s

First PD-1 receptor blocking antibodies enter clinical trials

2012

EU Approval of the 1st new agent for r/r HL in over 30 years



2016

EU Approval of the 1st HL consolidation treatment post-ASCT

 Seattle Genetics

 Takeda
ONCOLOGY

Takeda Oncology is the oncology business unit brand of Takeda Pharmaceutical Company Limited. Takeda Oncology and its logo are trademarks of Takeda Pharmaceutical Company Limited. Seattle Genetics and its logo are trademarks of Seattle Genetics, Inc.

GON/NON/16/0019 USP-COR-2016-0103(1)

Gürzenich Congress Center

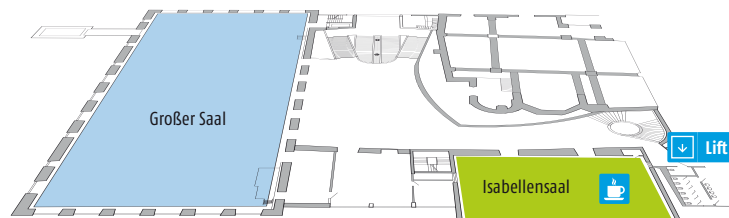

First Level

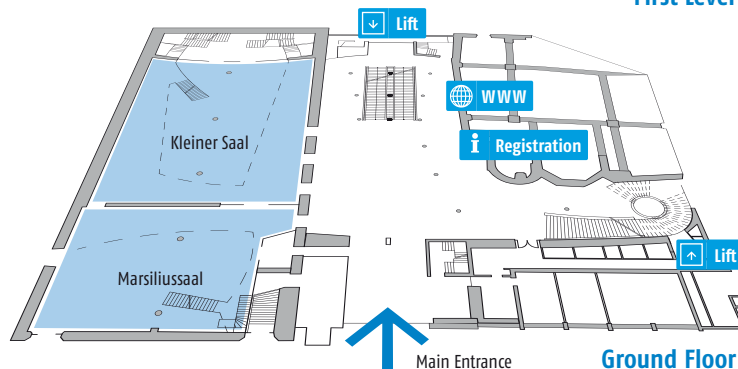

Ground Floor

First Level "Großer Saal"

Sat. 22.10.2016	Hematology Educational, Workshops, Satellite Symposia
Sun. 23.10.2016	Scientific Program, Workshop, Satellite and Lunch Symposium Opening Ceremony
Mon. 24.10.2016	Scientific Program, Satellite, Lunch and Dinner Symposium
Tue. 25.10.2016	Scientific Program, Satellite and Lunch Symposium, Closing Remarks

First Level "Isabellensaal"

Sat. 22.10.2016	Workshops
Sun. – Tue. 23.–25.10.2016	Exhibition Hall, Coffee Bar

Ground Floor "Kleiner Saal"

Sat. 22.10.2016	Workshops
Sun. 23.10.2016	Workshop, Welcome Reception
Mon./Tue. 24./25.10.2016	Posterviewing
Tue. 25.10.2016	Poster Walk

Ground Floor "Marsiliussaal"

Sun. 23.10.2016	Workshop
-----------------	----------

Foyer Ground Floor

Sat. – Tue. 22.–25.10.2016	Registration, Internet, Speakers Ready Room
----------------------------	---------------------------------------------

Basement: WC

SAVE THE DATE

11 International Symposium on Hodgkin Lymphoma
October 26–29, 2019

Further information will be available at
www.hodgkinsymposium.org

ISHL 11



**ISHL10
for your mobile**

Please bookmark URL or use QR-Code
ISHL10.hodgkinsymposium.org